

This document contains:

- The Event Covid-19 risk assessment and risk mitigation plan in accordance with the [FEI Policy for Enhanced Competition Safety during the Covid-19 Pandemic](#)
- The Event Approved Schedule

Given the current covid-19 situation, please note that the FEI's approval of a Schedule should not be taken as an absolute guarantee that the Event will definitely go ahead. The decision whether the Event can take place must be made by the OC and NF in close consultation with the applicable domestic government and public health authorities. It is the responsibility of each Participant to check the status of the Event prior to planning his/her travel to the Event.

Risk assessment for COVID-19

The questions below will enable OCs to review the additional considerations specific to sports, and thus inform their risk assessment of COVID-19 associated with their Event. This will help OCs understand and manage any additional risk from COVID-19.

The risk assessment should be reviewed and reassessed regularly during the planning phase and updated immediately prior to the transition to the operational phase, especially in light of the rapidly evolving nature of the outbreak. Reference should be made to the latest technical guidance and situation reports on the WHO website.

The risk assessment for COVID-19 associated with the Event must be coordinated and integrated with the host country's national risk assessment for COVID-19. The person completing the questionnaire should include input from the local public health authorities, consult WHO's latest technical guidance and ensure that there is an up-to-date evaluation of the epidemiological situation.

Please answer Yes (1) or No (0) to the following questions to determine a risk assessment score that incorporates factors specific to sporting events

Additional risk of COVID-19 to the sporting event	Yes (1)/No (0)	Score
Will the event be held in a country that has documented active local transmission of COVID-19 (community spread)?	1	1
Will the event be held in a single venue or multiple venues/cities/countries? <i>(single venue = 0; multiple venues = 1)</i>	0	0
Will the event include international participants (athletes and spectators) from countries that have documented active local transmission of COVID-19 (community spread)? <i>(NB: if the Events does not involve spectators, please clarify this in the comments to the questions in relation to spectators in the "Mitigation Checklist" sheet)</i>	1	1
Will the event include a significant number of participants (athletes or spectators) at higher risk of severe COVID-19 disease (e.g., people over 65 years of age or people with underlying health conditions)?	0	0
Will the event include sports that are considered at higher risk of spread for COVID-19 (eg, contact sports)?	0	0
Will the event be held indoors? <i>(Yes = 1; No = 0)</i>	1	1
Total COVID-19 risk score		3

Mitigation checklist for COVID-19

Mitigation measures assess the current effort and planning to reduce the risk of spread of COVID-19 disease for the event. As mitigation measures can reduce the overall risk of the sporting event contributing to the spread of COVID-19, they should be taken into account after the risk assessment has occurred to gain a clearer understanding of the overall risk of transmission and further spread of COVID-19, should the event be held. Together with the risk assessment score, the mitigation measure will contribute to the decision matrix and influence the assessment of the overall risk of transmission and further spread of COVID-19 in relation to the event.

Topic	Key consideration	Score Yes/Completed (2), Maybe/In progress (1), No/Not considered (0)	Weighting	Total score	Comments
Understanding of the overview of the current COVID-19 situation by the OC	Have the relevant OC and responsible staff been informed about the latest available guidance on the COVID-19 outbreak (official web resources available from WHO, CDC, ECDC, UN, local public health authorities)? And are the OC and staff concerned committed to following the available guidance?	2	1	2	(https://www.who.int/publications-detail/key-planning-recommendations-for-mass-gatherings-in-the-context-of-the-current-covid-19-outbreak)
	Is the OC aware of global and local daily situation reports as provided by WHO or local public health authorities?	2	1	2	
	Do the OC and responsible staff understand the risks and transmission routes of COVID-19, the steps that Event attendees can take to limit spread, the recognized best practices (including respiratory etiquette, hand hygiene, physical distancing, etc.), and the travel restrictions adopted by different countries that may affect the Event?	2	1	2	The Organisers check global and local situation reports published on WHO and local epidemiological authorities websites.
Event emergency preparedness and response plans	Has a contingency medical response plan for COVID-19 been developed for the Event?	2	3	6	
	Does the contingency medical response plan include information about how attendees should interact with the host country healthcare system (e.g. hotline/helpline telephone number, medical teams and first-aid points for the Event, local health care system)?	2	3	6	
	Is there an Emergency COVID-19 Outbreak Response Coordinator/Team in the OC or other structure structure for the Event with defined roles and responsibilities, coordinating the health preparedness and response planning for the outbreak?	2	2	4	
	Has the host country or OC requested support from WHO and/or local public health authorities ?	1	3	3	
	Has the OC acquired the following supplies to help reduce the risk of transmission of COVID-19?				
	Personal protective equipment (e.g. masks, gloves, gowns) for onsite medical personnel	2	3	6	The organiser acquired personal protective equipment (masks, gloves, hand sanitisers) for onsite medical team.
	Hand sanitizer and alcohol rubs/gels, tissues, frequently replaced soap canisters and closed bins for safe disposal of hygienic materials (e.g. tissues, towels, sanitary products) in washrooms and changing rooms	2	3	6	The organiser acquired hand sanitisers, soap, paper towels and closed bins for safe disposal of hygienic materials in sanitary facilities.
	Hand sanitizers and alcohol rubs for all entrances and throughout the venue	2	3	6	multiple location on the venue, including entrances to the stables,
	If a person feels unwell/ shows symptoms of an acute respiratory infection during the Event:				
	Is there a procedure for athletes or spectators to clearly identify whom to contact and how to do so if they or other Event participants feel unwell?	2	3	6	

	Is there a protocol on whom the OC should contact in the host country to report suspected cases and request testing and epidemiological investigations?	2	3	6	
	Are first-aid services or other medical services in-place and equipped to support patients with respiratory symptoms?	2	2	4	
	Are there isolation rooms or mobile isolation units available onsite?	2	2	4	There will be prepared an isolation room if needed.
	Are there any designated medical facilities that manage patients with COVID-19 infection in the host country?	2	2	4	contagious diseases hospitals, so that they could handle only patients with suspected or confirmed coronavirus SARS COoV-2
	Are there transportation services with trained medical professionals available to transport critically ill patients with severe acute respiratory infections to a hospital or to evacuate them from the host country, if necessary?	2	2	4	
	Has a cleaning schedule been developed to ensure the venue is clean and hygienic – wiping surfaces and any equipment regularly with disinfectant is strongly recommended (before, during and after the event and between each round of competition)?	2	3	6	A cleaning schedule of the vanue has been developed.
	Are there established screening measures , including temperature checks in place for participants at the point of entry, venues, routes and on-site medical facilities (first-aid points)? (Please specify in Comments what these screening measures include)	2	3	6	All participants and Athlets undergo body temperature checks everyday.
	Is the host country conducting COVID-19 laboratory diagnostic tests ? (If Yes, please specify in comments the type of COVID-19 diagnostic test used)	2	3	6	
	Does the host country have a national public health emergency preparedness and response plan that can address severe respiratory diseases, including COVID-19?	2	2	4	
	Is there a preliminary agreement by the host country to provide care for any COVID-19 cases connected with the Event?	2	3	6	
	If the Event is for a duration of 14 days or longer, does the medical response plan for the event include resources and protocols for managing all public health interventions that would be necessary and supporting the national public health authorities if participants are infected and become unwell at the Event? (If the event is for less than 14 days, please score 0)	0	3	0	
	If the Event is for less than 14 days, does the medical response plan include protocols for OCs to notify all participants of possible exposure to COVID-19 if the OCs are made aware of any suspected or confirmed cases that attended the Event? (If the event is for 14 days or longer, please score 0)	2	3	6	
Stakeholder and partner coordination	Is there an established mechanism for collaboration and coordination between the health and security sectors , which is considered as crucial?	2	2	4	
	Are there agreed, clear and easily understood processes in place for reporting to external multi-sectoral stakeholders (including surveillance authorities, WHO, CDC, ECDC, etc.) and disseminating risk communication messages (Media)?	2	2	4	
Command and control	Is there a decision-making authority/body and an agreed procedure to modify, restrict, postpone or cancel the Event related to the evolving COVID-19 outbreak?	2	3	6	Elzbieta Szary - President of the Event
	Are there arrangements to activate a strategic health operations centre if there are suspected COVID-19 cases in connection with the Event?	2	2	4	
	Have the OC and staff undergone training and exercises on personal safety procedures and emergency mitigation measures (including those specifically listed in this checklist)?	2	3	6	

Risk communication	Is there a risk communication strategy for the Event in regard to COVID-19?	2	3	6	
	Is there a designated person(s) to lead media activities and tasked with managing all external communications with national and international government officials, the general public, and the media? (If yes, please identify the spokesperson in comments)	2	2	4	Gabriela Skotniczny - Press Officer
	Has there been monitoring of national and international media and social media established for rumours to be able to counter them early? (Please explain in the comments what protocols are in place for counter messaging)	2	2	4	
	Has coordination been set up with major official media channels and social media sites such as Twitter, Facebook and Instagram so that messaging can be coordinated with, and assisted by, the platforms to provide targeted messaging from OCs (including messaging to counter fake news and rumours, and proactive messaging about the status of the sporting event, including changes)?	2	2	4	
Public health awareness of COVID-19 before and during the event	Has public health advice on clinical features of COVID-19, preventive measures, especially respiratory etiquette, hand hygiene practices, and physical distancing, been shared with all staff involved in the Event, athletes, the public, and personnel of all relevant stakeholders?	2	3	6	
	Has information on the at-risk populations been provided to all athletes, the public and others so they may make an informed decision on their attendance based on their personal risks?	2	3	6	
	Has public advice included information on the meaning of the following measures: quarantine, self-isolation and self-monitoring ?	2	2	4	
Surge capacity	Are there any surge arrangements in place in the event of a public health emergency during the Event - (i.e. suspected and confirmed cases of COVID-19?				
	Do these surge arrangements include funding for mitigation measures?	2	3	6	
	Do these surge arrangements include stockpiles of equipment (e.g. personal protective equipment, etc.)	2	3	6	
	Do these surge arrangements include training of extra staff?	2	2	4	
	Do these surge arrangements include volunteers?	2	2	4	
Specific mitigation measures	Will there be daily health checks of athletes/competitors?	2	2	4	places of temperature checks on Arrival.
	Will the athletes be separated from other groups , such as officials, support staff and spectators, to limit transmission?	2	2	4	According to Polish Equestrian Federation regulations, Athletes will be allowed in the stable zones, parking zones, show office zone and competition zone while keeping 2m distances from other participants. Athletes are not allowed in jury boxes. All participants must wear mask in all indoor zones - its only allowed to ride a horse without mask.
	Are there measures in place to limit the sharing of equipment, water bottles, towels , etc.?	2	3	6	In showjumping no equipment is shared by Athletes.
	Will athletes be given closed containers to allow for the safe disposal or storing of all hygienic materials (e.g. tissues, towels, etc.)?	0	3	0	In sanitary facilities only single-use hygienic materials will be available, as well as closed containers for their disposal.
	Will the Event have designated seating for all spectators?	2	3	6	
	Does the designated seating provided allow for physical distancing between spectators (minimum of 1 metre)?	2	2	4	
	Have pre-travel health checks been performed on all athletes to ensure underlying comorbidities, medications, allergies, etc. are documented?	0	2	0	

Sum of mitigation measures	207
----------------------------	-----

207

Total mitigation score (%)	94
----------------------------	----

Event overall risk score

The decision matrix takes the risk score and the mitigation score to provide a colour determination. This colour determination identifies the total risk of transmission and further spread of COVID-19 in relation to the Event. The "Colour Determination" key below the decision matrix describes the total risk for each colour.

Total COVID-19 risk score (from "Risk Assessment" Tab)	3
--	---

Total mitigation score (from "Mitigation Checklist" Tab)	94
--	----

Risk Vs. Mitigation Matrix

Total Risk Assessment Score	Very Prepared to Mitigate COVID-19 Impacts (76-100)	Somewhat Prepared to Mitigate COVID-19 Impacts (51-75)	Somewhat Unprepared to Mitigate COVID-19 Impacts (26-50)	Very Unprepared to Mitigate COVID-19 Impacts (0-25)
0 - Negligible	Very low	Very low	Very low	Very low
1 - Very Low Risk	Very low	Very low	Low	Low
2 - Low Risk	Low	Low	Low	Moderate
3 - Moderate Risk (low-moderate)	Low	Moderate	Moderate	Moderate
4 - Moderate Risk (high-moderate)	Moderate	Moderate	High	Very High
5 - High Risk	High	High	Very High	Very High
6 - Very High Risk	Very High	Very High	Very High	Very High

KEY FOR COLOUR DETERMINATION OF OVERALL RISK	
VERY LOW	Overall risk of transmission and further spread of COVID-19 in relation to the Event is considered <u>very low</u> .
LOW	Overall risk of transmission and further spread of COVID-19 in relation to the Event is considered <u>low</u> . Recommend checking whether mitigation measures can be strengthened.
MODERATE	Overall risk of transmission and further spread of COVID-19 in relation to the Event is considered <u>moderate</u> . Recommend <u>significant</u> efforts to improve mitigation measures or reduce risk of transmission (decrease risk assessment score).
HIGH	Overall risk of transmission and further spread of COVID-19 in relation to the Event is considered <u>high</u> . Recommend <u>significant</u> efforts to improve <u>both</u> mitigation measures and reduce risk of transmission (decrease risk assessment score).
VERY HIGH	Overall risk of transmission and further spread of COVID-19 in relation to the Event is considered <u>very high</u> .



RISK MITIGATION PLAN

Cracovia Szary Equestrian Show

Michalowice

21-24.10.2021

&

28-31.10.2021

Introduction

Due to Covid-19 pandemic, we kindly ask you to familiarize with this document to minimise risk of infection.

Despite following these Guidelines that are to reduce to minimum risk of infection with Covid-19 during the competition this risk is not eliminated.

Every Participant of the event is obliged to familiarize with these Guidelines. Negligence of acknowledgment of the Guidelines doesn't relive from the duty of following the rules.

All the Participants of the event (excluding Organiser's employees) are taking part voluntarily and on their own responsibility.

All Participants are required to comply with the rules of social coexistence and conduct in accordance with applicable law and regulation of these Guidelines and other regulations in force in the competition established by the Organiser.

All who decide to take part in the event (in any role) and are allowed to participate in the event by Organiser during the pandemic are doing so at their own risk.

The Organising Committee doesn't take any responsibility for infection with Covid-19 of anyone taking part in the event.

Participant of the event

A Participant of the event is a person whose presence on the showground is essential for the sports competition, in particular:

- Competitor
- Supporting personnel- trainer, groom, horse owner and responsible person of a minor athlete
- Person responsible for horse transport
- Official
- Event staff
- Security staff
- TV operators
- Media representatives
- Spectators

Restrictions of participation

The following restriction of participation in the event must be followed:

- The event takes place with spectators - in accordance with current regulations in Poland.
- A rider is entitled to accreditation for one groom and two assisting persons.
- Each National Federation is entitled to accreditation for one additional person to represent the National Federation.
- Only healthy individuals with temperature less than 37.5 °C from the accredited list will be given access to the showground
- Press Office will work only as remotely (online). The number of Press Office Staff will be limited.

The procedure of entering the showground

- All the Participants of the event are entering the showground using only the entry or gate specified by Organiser.
- At the control point, Security Staff checks and verify all the participants, does a health interview and measures the temperature.
- A measurement of the temperature is an obligatory procedure and it's anonymous. 4. If temperature is greater than 37.5 degrees C the person cannot enter the venue
- Refusing to follow the procedure of taking the temperature results denning the access to the showground.
- During the control procedure, Security Staff has a right to: a) Ask for an ID document b) Ask to leave the vehicle
- Each Participant given the access the showground will be marked with a wristband.
- In case of any health issues reported by any Participant Security staff will not give an access to the showground and will inform the Organiser and Medical Staff.
- Each Participant is responsible for going through the control point and the procedure of entering the showground to get the wristband for the day.
- Entering the showground without the wristband will result with an admin charge 100 EUR and in case of repeated violation of the rules expelling from the showground.

Security on the showground

1. Each of the Participants must :
 - a) Cover the mouth and nose using the mask and keep a 2m distance from other participants only indoors
 - b) Systematically sterilising hands at the stations located in toilets area, show office, competition zone, stables.
2. The Organiser will assign a Steward who with cooperation with the Organiser will coordinate and supervise the security system especially the logistic of Participants, access to sanitizers, covering mouth and nose by Participants
3. All the rooms used during the event will be disinfected after each day of the event.

The most common symptoms of Covid-19 are fever, dry cough, and tiredness. Other symptoms that are less common and may affect some patients include aches and pains, nasal congestion, headache, conjunctivitis, sore throat, diarrhoea, loss of taste or smell or a rash on skin or discoloration of fingers or toes. These symptoms are usually mild and begin gradually (Source: WHO website: <https://www.who.int/emergencies/diseases/novelcoronavirus-2019/question-and-answers-hub/q-a-detail/q-a-coronaviruses>) and the Participants must immediately: 1. Go to the assigned by the Organiser isolation space. 2. Call the Organizer on 0048607797030 The Organiser will contact with the Regional Sanitary and Epidemiological Station, competent for the showground of the event, or the 24-hour NFZ hotline 800-190-590.

Limitations and guidelines for specific groups of Participants

1. ATHLETES:

Athletes can access Car Park zone, Stables, Show Office and Competition zone where they need to keep 2 m of social distance.

Minor Athletes can be accompanied by his/her representative (one per Athlete).

Athletes are not allowed to enter the Ground Jury box.

All the issues are solved remotely. All official protests are managed in the Show Office as per PZJ and FEI rules. • Course walking takes place with keeping 2m social distance rule.

2. TRAINERS

Trainers can access Car Park zone, Stables, Show Office and Competition zone where they need to keep 2 m of social distance.

Because of limitations of direct contact, the trainer is allowed to enter the warm up area only when the rider is jumping, 15 min before the start.

Limitations and guidelines for specific groups of Participants

3. GROOMS AND SUPPORTING TEAM

Grooms can access Car Park zone, Stables and Competition zone outside the warm up area and competition area where they need to keep 2m of social distance.

In case the rider is not accompanied by the trainer, the groom is allowed to enter the warm up area only when the rider is jumping, 15 min before the start.

Supporting Team can access Car Park zone, Stables and Competition where they need to keep 2 m of social distance.

1.OFFICIALS • Officials i. e. judges, scribes, Ground Jury wear a mask in the judge box.

2.CAR PARK ZONE • Only Participants of the Event have access to Car Park Zone. • A distance of 1 m between vehicles have to be kept. • All Participants in the Car Park Zone has to keep 2 m distance • Any gathering of more than 10 persons are strictly forbidden in Car Park Zone.

Limitations in the Show Office

1. The distance between each working post must be 2m or post have to be divided with a screen or everyone has to wear a head shield.
2. The number of people allowed in the Show Office is determined on the square meter space- the coefficient should be 10m² per 1 person under condition there's one person being served at the post.
3. Access to Show Office is only limited to Staff, Officials, Athletes and Supporting Team.

Limitations for media

1. Press Office will work only as remotely (online).
2. The number of Press Office Staff will be limited only to accredited press.
3. Access to the showground is only given to: • Press Office Staff- press staff, social media staff, photo staff, video staff • Media Partners representative- one per editorial • FEI accredited media- FEI TV, photographer • TV coverage staff • Online coverage staff
4. The Organiser will not provide for accredited media the Press Office or the Media Room. All Media representatives need to follow the procedure of temperature measurement every day. Also, they must inform the Organiser about the most common symptoms of Covid 19. The most common symptoms of Covid-19 are fever, dry cough, and tiredness. Other symptoms that are less common and may affect some patients include aches and pains, nasal congestion, headache, conjunctivitis, sore throat, diarrhoea, loss of taste or smell or a rash on skin or discoloration of fingers or toes. These symptoms are usually mild and begin gradually. (Source: WHO website: <https://www.who.int/emergencies/diseases/novel-coronavirus-2019/question-and-answers-hub/q-a-detail/q-acoronaviruses>)

Limitations for Sponsors

1. The number of Sponsor representatives who will have access to the showground and to the specific zones will be limited.
2. Sponsor representatives are only allowed to access Competition zone All Sponsor representatives need to follow the procedure of temperature measurement every day. Also, they must inform the Organiser about the most common symptoms of Covid 19. The most common symptoms of Covid-19 are fever, dry cough, and tiredness. Other symptoms that are less common and may affect some patients include aches and pains, nasal congestion, headache, conjunctivitis, sore throat, diarrhoea, loss of taste or smell or a rash on skin or discoloration of fingers or toes. These symptoms are usually mild and begin gradually. (Source: WHO website: <https://www.who.int/emergencies/diseases/novel-coronavirus-2019/question-and-answers-hub/q-a-detail/q-a-coronaviruses>)

Limitations for trade stands

- 1.The number of trade stands at the event is limited.
- 2.All the stands at the event must follow the Guidelines of Polish government on providing safety for employees and customers during a pandemic.
- 3.The distance between the employees should be 1,5 m and if that's impossible all employees should have Personal Protective Equipment.
- 4.All individuals queuing should keep min. 1,5 m distance
- 5.At the entrance and at the till point there should be hand sanitizer available All the staff of trade stands need to follow the procedure of temperature measurement every day. Also, they must inform the Organiser about the most common symptoms of Covid 19. The most common symptoms of Covid19 are fever, dry cough, and tiredness. Other symptoms that are less common and may affect some patients include aches and pains, nasal congestion, headache, conjunctivitis, sore throat, diarrhoea, loss of taste or smell or a rash on skin or discoloration of fingers or toes. These symptoms are usually mild and begin gradually. (Source: WHO website: <https://www.who.int/emergencies/diseases/novel-coronavirus-2019/question-and-answers-hub/q-a-detail/q-acoronaviruses>).

Limitations for hospitality/ catering

1. All the stands at the event must follow the Guidelines of Polish government on providing safety for employees and customers during a pandemic.
2. The distance between the employees should be 1.5m and if that's impossible all employees should have Personal Protective Equipment.
3. All individuals queuing should keep min. 1,5 m distance
4. At the order collecting points and till points there should be hand sanitizer available
5. Tables should have a min. 1,5 m distance.
6. All the tables should be disinfected after each use. All the hospitality/ catering staff need to follow the procedure of temperature measurement every day. Also, they must inform the Organiser about the most common symptoms of Covid 19. The most common symptoms of Covid-19 are fever, dry cough, and tiredness. Other symptoms that are less common and may affect some patients include aches and pains, nasal congestion, headache, conjunctivitis, sore throat, diarrhoea, loss of taste or smell or a rash on skin or discoloration of fingers or toes. These symptoms are usually mild and begin gradually. (Source: WHO website: <https://www.who.int/emergencies/diseases/novel-coronavirus-2019/question-and-answers-hub/q-a-detail/q-acoronaviruses>).

People vaccinated against Covid-19 disease do not count towards people listed in this presentation.

Appendix

HOW TO WEAR A NON-MEDICAL FABRIC MASK SAFELY

Do's →

1 Clean your hands before touching the mask

2 Inspect the mask for damage or if dirty

3 Adjust the mask to your face without leaving gaps on the sides

4 Cover your mouth, nose, and chin

5 Avoid touching the mask

6 Clean your hands before removing the mask

7 Remove the mask by the straps behind the ears or head

8 Pull the mask away from your face

9 Store the mask in a clean plastic, resealable bag if it is not dirty or wet and you plan to re-use it

10 Remove the mask by the straps when taking it out of the bag

11 Wash the mask in soap or detergent, preferably with hot water, at least once a day

12 Clean your hands after removing the mask

A fabric mask can protect others around you. To protect yourself and prevent the spread of COVID-19, remember to keep at least 1 metre distance from others, clean your hands frequently and thoroughly, and avoid touching your face and mask.

[who.int/epi-win](https://www.who.int/epi-win)  World Health Organization

Appendix

HOW TO WEAR A NON-MEDICAL FABRIC MASK SAFELY

Don'ts →

- 
Do not use a mask that looks damaged
- 
Do not wear a loose mask
- 
Do not wear the mask under the nose
- 
Do not remove the mask where there are people within 1 metre
- 
Do not use a mask that is difficult to breathe through
- 
Do not wear a dirty or wet mask
- 
Do not share your mask with others

A fabric mask can protect others around you. To protect yourself and prevent the spread of COVID-19, remember to keep at least 1 metre distance from others, clean your hands frequently and thoroughly, and avoid touching your face and mask.

[who.int/epi-win](https://www.who.int/epi-win)  World Health Organization

Appendix



HOW TO WASH YOUR HANDS

Clean hands protect against infection



www.ncheurope.com

[Contact us for more information](#)

[Discover our hand care line](#)

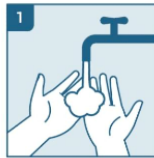

1 Wet hands

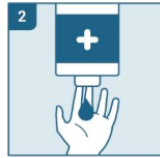

2 Use enough soap to cover all hand surfaces

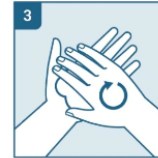

3 Rub hands palm to palm



4 Right palm over left dorsum and left palm over right dorsum



5 Palm to palm with fingers interlaced

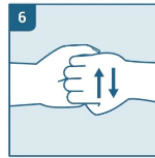

6 Backs of fingers to opposing palms with fingers interlocked

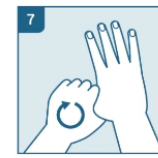

7 Rotational rubbing of right thumb clasped in left palm and vice versa

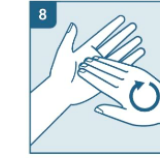

8 Rotational rubbing backwards and forwards with clasped fingers of right hand in left palm and vice versa

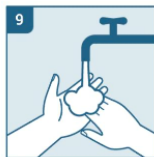

9 Rinse hands with water



10 Dry hands thoroughly with a single use towel

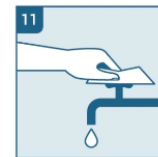

11 Use the towel to turn off the tap

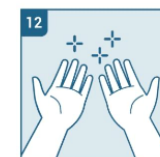

12 Your hands are clean

I. DENOMINATION OF THE EVENT

Venue: **Michalowice, Kraków, POLAND**

Date: **21-24.10.2021; 28-31.10.2021** NF: **POL**

Indoor: Outdoor:

EVENT CATEGORIES:

CSIO5* <input type="checkbox"/>	CSI5*-W <input type="checkbox"/>	CSI5* <input type="checkbox"/>	CSIU25-A <input type="checkbox"/>	CSIU25-B <input type="checkbox"/>
CSIO4* <input type="checkbox"/>	CSI4*-W <input type="checkbox"/>	CSI4* <input type="checkbox"/>	CSIY-A <input type="checkbox"/>	CSIY-B <input type="checkbox"/>
CSIO3* <input type="checkbox"/>	CSI3*-W <input type="checkbox"/>	CSI3* <input type="checkbox"/>	CSIJ-A <input type="checkbox"/>	CSIJ-B <input type="checkbox"/>
CSIO2* <input type="checkbox"/>	CSI2*-W <input type="checkbox"/>	CSI2* <input checked="" type="checkbox"/>	CSIch-A <input type="checkbox"/>	CSIch-B <input type="checkbox"/>
CSIO1* <input type="checkbox"/>	CSI1*-W <input type="checkbox"/>	CSI1* <input checked="" type="checkbox"/>	CSIV-A <input type="checkbox"/>	CSIV-B <input type="checkbox"/>
CSIOY <input type="checkbox"/>		CSIL1* <input type="checkbox"/>	CSIAm-A <input type="checkbox"/>	CSIAm-B <input type="checkbox"/>
CSIOJ <input type="checkbox"/>		CSIYH2* <input type="checkbox"/>	CSIP <input type="checkbox"/>	
CSIOPI <input type="checkbox"/>		CSIYH1* <input checked="" type="checkbox"/>		
CSIOCh <input type="checkbox"/>				

Championship Games

II. GENERAL CONDITIONS

- FEI Statutes, 24th edition, effective 19 November 2019
- FEI General Regulations, 24th edition, 1st January 2020
- FEI Veterinary Regulations, 14th edition, 1 January 2018, updates effective 1st January 2020
- The Jumping Rules and its Annexes, 26th edition, updates effective 1 January 2020
- <https://inside.fei.org/fei/regulations/jumping>
- CSI/CSIO Prize Money requirements 2020
<https://inside.fei.org/sites/default/files/Final%20CSIs-CSIOs%20-%202020.pdf>
- Longines Rankings – Groups Categories 2020
<https://inside.fei.org/sites/default/files/Final%20Longines%20Ranking%20Groups%20-%202020.pdf>
- Equine Anti-Doping and Controlled Medication Regulations (EADCMR), 2nd Edition, effective 1 January 2015, updates effective 1st January 2020
- FEI Anti-Doping Rules for Human Athletes (ADRHA), based upon 2015 WADA Code, effective 1 January 2015
- The FEI Policy for Enhanced Competition Safety during the Covid-19 Pandemic, effective as of 1 July 2020 and until further notice
- All subsequent published revisions/updates, the provisions of which will take precedence.

THE ANNEXE(S) IS/ARE PART OF THIS APPROVED AND SIGNED SCHEDULE AND MUST BE DISTRIBUTED TO ALL OFFICIALS AND NFs AND IS AVAILABLE TO OTHERS UPON REQUEST

Approved by the FEI, Lausanne, on 17/09/2021.

NB: No modifications to the approved Schedule will be accepted less than two weeks prior to the event. Additionally, no change may be made to a Longines Ranking competition once the schedule has been approved. Prizes in kind, to be accepted as prize money to count for Longines Ranking competitions and total event prize money, must be easily convertible into cash (GRs Art. 127).

TABLE OF CONTENTS

I.	DENOMINATION OF THE EVENT	1
II.	GENERAL CONDITIONS	1
III.	THE FEI CODE OF CONDUCT FOR THE WELFARE OF THE HORSE	3
IV.	GENERAL INFORMATION	4
1.	ORGANISER	4
2.	ORGANISING COMMITTEE	4
3.	EVENT DIRECTOR	4
4.	STABLE MANAGER.....	4
5.	ANNOUNCER	4
V.	OFFICIALS	5
VI.	INVITATIONS	6
1.	GENERAL.....	6
VII.	ENTRIES	10
1.	ENTRY DATES AND ENTRY FEES.....	10
2.	OTHER FEES	11
3.	NO-SHOWS/LATE WITHDRAWALS.....	12
VIII.	TIMETABLE.....	13
IX.	COMPETITION DETAIL.....	17
X.	FACILITIES OFFERED.....	33
1.	ATHLETES.....	33
2.	GROOMS.....	33
XI.	LOGISTICAL/ADMINISTRATIVE/TECHNICAL INFORMATION	34
1.	DRAW	34
2.	COMPETITION ARENA(S)	34
3.	PRACTICE ARENA(S)	34
4.	STABLES	34
5.	SAFETY CUPS.....	34
6.	TIMING DEVICE	34
7.	SCORING/TIMING PROVIDER.....	34
8.	OTHER TECHNOLOGY/SERVICE PROVIDER(S)	35
9.	PRIZE GIVING CEREMONY	35
10.	ADVERTISING ON ATHLETES AND HORSES.....	35
11.	TICKETING.....	35
12.	BETTING.....	35
13.	TRANSPORT REIMBURSEMENT HORSES / PONIES	35
14.	WELCOME.....	35
15.	LOCAL TRANSPORTATION - ARRANGEMENTS FROM HOTEL TO SHOWGROUNDS	35
16.	ENTRY RIGHT TO SHOWGROUNDS/ACCREDITED PERSONS.....	36
17.	SUSTAINABILITY.....	36
XII.	VETERINARY MATTERS.....	37
1.	CUSTOMS FORMALITIES	37
2.	HEALTH REQUIREMENTS	37
3.	NATIONAL REQUIREMENTS	37
4.	PONIES.....	37
5.	INJURY SURVEILLANCE.....	38
6.	TRANSPORT OF HORSES.....	38
7.	VENUE ARRIVAL INFORMATION & FITNESS TO COMPETE	38
8.	EQUINE ANTI-DOPING AND CONTROLLED MEDICATION PROGRAMME (EADCMP). FEI VETERINARY REGULATIONS,	

CHAPTER VII	39
XIII. HUMAN ANTI-DOPING	40
XIV. ADDITIONAL INFORMATION	40
1. THE FEI POLICY FOR ENHANCED COMPETITION SAFETY DURING THE COVID-19 PANDEMIC.....	40
2. INSURANCES AND NATIONAL REQUIREMENTS.....	41
3. PROTESTS/APPEALS.....	42
4. SCHOOLING DURING COMPETITIONS.....	42
5. STEWARDING.....	42
6. DISPUTES	43
7. MODIFICATION TO SCHEDULE	43
8. ADDITIONAL INFORMATION FROM THE OC.....	43
9. PRIZE MONEY DISTRIBUTION.....	45
10. MAXIMUM NUMBER OF STARTERS PER COMPETITION	46
11. GLOSSARY	47
XV. ANNEXES.....	49

III. THE FEI CODE OF CONDUCT FOR THE WELFARE OF THE HORSE

The Fédération Equestre Internationale (FEI) expects all those involved in international equestrian sport to adhere to the FEI's Code of Conduct and to acknowledge and accept that at all times the welfare of the horse must be paramount and must never be subordinated to competitive or commercial influences.

1. At all stages during the preparation and training of competition horses, welfare must take precedence over all other demands. This includes good horse management, training methods, farriery and tack, and transportation.
2. Horses and Athletes must be fit, competent and in good health before they are allowed to compete. This encompasses medication use, surgical procedures that threaten welfare or safety, pregnancy in mares and the misuse of aids.
3. Events must not prejudice horse welfare. This involves paying careful attention to the competition areas, ground surfaces, weather conditions, stabling, site safety and fitness of the horse for onward travel after the event.
4. Every effort must be made to ensure that horses receive proper attention after they have competed and that they are treated humanely when their competition careers are over. This covers proper veterinary care, competition injuries, euthanasia and retirement.
5. The FEI urges all involved with the sport to attain the highest levels of education in their areas of expertise.

The **Long version** of this Code can be obtained from the Fédération Equestre Internationale, HM King Hussein I Building, Chemin de la Joliette 8, 1006 Lausanne, Switzerland. Telephone: +41 21 310 47 47. The Code is available in English. The Code is also available on the FEI's website: <http://inside.fei.org/>.

IV. GENERAL INFORMATION

1. ORGANISER

Name: Stowarzyszenie Klub Sportowy Klub Jazdy Konnej Szary
Address: ul. Parkurowa 3; 32-091 Michałowice
Telephone: Anna Szary-Ziębicka +48 607797030 Michał Ziębicki +48 601422782
Email: zawody@kjkszary.pl
Website: www.kjkszary.pl

Contact Details Show Ground:

Address: ul. Parkurowa 3; 32-091 Michałowice
Telephone: Anna Szary-Ziębicka +48 607797030 Michał Ziębicki +48 601422782
GPS Coordinates: 50.151505 19.980463
Accessibility details (directions by road, nearest airport / train station): [Kraków Airport \(KRK\) <http://krakowairport.pl/>](#)

2. ORGANISING COMMITTEE

Honorary President: Mirosław Szary
President of the Event: Elżbieta Szary
Show Secretary: Oliwia Dymek
Press Officer: Gabriela Skotniczny

3. EVENT DIRECTOR

Name: Anna Szary-Ziębicka
Address: ul. Parkurowa 3; 32-091 Michałowice
Telephone: +48 607797030
Email: zawody@kjkszary.pl

4. STABLE MANAGER

Name: Adam Węglorz
Telephone: +48 531388262
Email: zawody@kjkszary.pl

5. ANNOUNCER

Name: Zuzanna Ostańska
Email: zu.ostanska@gmail.com

V. OFFICIALS

* Compulsory

In case there are several categories and officials are not the same, please complete an additional chart per category.

Ref.	Panel	Function	FEI ID	Name	NF	Level	E-mail & Mobile
1	Ground Jury	Ground Jury President	10051118	Dariusz Orzoł	POL	3	dariusz_o@people.pl +48 502 190 303
		Ground Jury Member	10134307	Małgorzata Melon	POL	2	
		Ground Jury Member	10051394	Zofia Jurczyńska-Kret	POL	3	
2	Foreign Judge	Foreign Judge	10050109	Radovan Salek	CZ	3	
3	Foreign Technical Delegate	Foreign Technical Delegate					
4	Course Designer	Course Designer	10052103	Szymon Tarant	POL	3	tarantevents@gmail.com
		Assistant Course Designer		Anna Skobrtal	POL	NAT	
		Assistant Course Designer		Piotr Staniszewski	POL	NAT	
5	Chief Steward	Chief Steward	10116088	Aleksandra Tutaj	POL	3	+48 501 219 226
6	Foreign Steward	Foreign Steward					
7	Assistants Stewards	Assistant Steward	10116083	Anna Bojarczuk	POL	2	
		Assistant Steward	10140023	Anna Bosiacka	POL	2	
		Assistant Steward	10169756	Alina Talik-Przechrzta	POL	1	
		Assistant Steward	10052979	Sylwia Bogacz	POL	3	
8	FEI Veterinary Delegate	FEI Veterinary Delegate	10049455	Andrzej Bereznowski	POL	3	
9	Veterinary Service Manager (VSM) (VR Art 1103)/Treating Veterinarian (VR Art 1105)	Veterinary Service Manager	10086691	Wojciech Kujawski	POL		+48 602 219 994
		FEI Permitted Treating Veterinarian	10086691	Wojciech Kujawski	POL		+48 602 219 994
10	Medical Doctor	Medical Doctor		Ryszard Budzyń	POL		+48 601 489 637
11	Farrier	Farrier		Adam Węglorz	POL		+48 531 388 262
12	NF Delegate	NF Delegate (if applicable)					*

Please note that the schedule has been approved under the provision that all appointed Officials have successfully passed the on-line FEI Competency Evaluation Test.

VI. INVITATIONS

1. GENERAL

Horses entered in one CSI star level may not enter another CSI star level at the same Event.

Horses may take part in national Competitions and international Competitions at the same Event only under the following conditions:

- Horses may take part in national Events up to two hours prior to the start of the international Event's Horse Inspection;
- If the national Event includes Competitions after the international Event ends, either on the same day or on the following day(s). Horses having taken part in the international Event may take part in national Competitions only, following the conclusion of the international Event.

Invitations

For all Events at which the CSI Invitation Rules apply, a certain percentage of Athletes must be invited in descending order of the Longines Ranking, a certain percentage of Athletes will be home Athletes selected by the host NF and a certain percentage will be Athletes invited by the Organising Committee (OC); the percentages for each invitation group are established for each star level as follows:

Event Level	Athletes from the Longines Ranking	Athletes selected by the host NF	OC Invitations
CSI 5*	60%	20%	20%
CSI 4*	50%	25%	25%
CSI 3*	40%	30%	30%
CSI 2*	30%	30%	40%
CSI 2* option with no Longines Ranking Competitions (option available only for CSI2* that are combined with CSI3*, 4* or 5*, upon specific request of the OC)	0%	20%	80%

Longines Rankings

The Longines Rankings number 246, established three (3) months prior to this Event will be used for the invitation of Athletes. Athletes are invited through the FEI online Invitation System for Jumping in accordance with the CSI Invitation Rules (refer to Jumping Rules Annex V)

CSI 2*:

Maximum number of Athletes to be invited: 80

Maximum number of Horses that may be entered: 240

Maximum number of Horses per Athlete: 3

Maximum number of Athletes invited	No. of Athletes from the Longines Ranking	No. of Athletes selected by the host NF	No. of OC Invitations
80	24	24	32

(OCs will be permitted to invite a limited number of additional Athletes, if, at the closing of entries, the maximum number of Horses that may be entered has not been reached. For details, please see the "Implementation of the FEI Online Invitation System for Jumping Guidelines".)

FEI Wild Cards:

CSI5*: 1

CSI4*/CSI3*: 2

Connected events:

There are no connected events in this show

Section 1: Compulsory Invitations

Athletes can choose Events for which they wish to receive an information from the Monday eight weeks prior to the week of the Event until midnight GMT on the 4th Sunday prior to the Event.

Section 2: Home Athletes selected by the host NF

Entries for home Athletes in this section must be made through the FEI Entry System between the Monday eight weeks prior to the week of the Event until midnight GMT on the 3rd Wednesday prior to the week of the Event.

Section 3: OC Invitations

Entries in the OC Invitation Quota can be made in the FEI Entry System from the Monday eight weeks prior to the week of the Event up until the closing date for regular entries (the closing date for regular entries cannot be earlier than the 3rd Thursday prior to the week of the Event, and no later than four days prior to the Event) as indicated in the Schedule.

Events for which the Schedule states that overseas air transportation of Horses will be provided/organised by the OC are, for logistical reasons, authorised to establish the closing date for entries at the earliest on the 5th Sunday prior to the event.

CSI1* :

NF's invited:	all NF are invited
Reserve NFs:	
Total number of athletes:	unlimited
Number of home athletes:	
Number of foreign athletes:	
Number of horses per athlete:	6 (max. 2 per class)

CSIYH1* :

NF's invited:	all NF are invited
Reserve NFs:	
Total number of athletes:	unlimited
Number of home athletes:	
Number of foreign athletes:	
Number of horses per athlete:	6 (max. 2 per category)

Athletes are invited by the Organiser through their National Federation.

One (1) groom per athlete.

Riders taking part in two weeks tournament will have priority in admission.
Horses of riders competing in CSI2* have priority.

Horses have to stay in CSI2*, CSI1*, CSI YH during one week, but can change from week to week during the tour.

Total maximum number of horses 350 per one week.

1. Athletes may take part in the CSI YH without taking part in CSI1* or CSI2*.
2. Each horse can start only in one competition per day and can start 3 times during each week.
3. Horses not competing during a week must be presented during Horse Inspection with passport to general health condition assessment.
4. After Horse Inspection no migrations between different events are allowed during the same week.
5. Any substitutions on start lists are allowed maximum 1 hour before competition, 4 hours before the Grand Prix.
6. Wherever in schedule, in definition of qualification, is used term "best rider", it means, that she/he must be ranked, i.e. she/he must complete a course it concerns.

STABLES ARE OPEN FROM:

Wednesday 20.10.2021 8.00 AM (1st week)

Wednesday 27.10.2021 8.00 AM (2nd week)

Early arrivals:

30euro/per horse/per day **ONLY AFTER EARLIER REQUEST**
ania.szary@kjkszary.pl

Due to the actual FEI Regulations all horses need to be checked upon arrival.
Therefore an arrival between 22.00 and 8.00 is not possible.!

All riders and horses participating only in 1st week need to leave the stables no later than 22.00 on Sunday 24.10.2021 so the OC can prepare and disinfect boxes for the next week.

VII. ENTRIES

IMPORTANT

- Entries must be made by NFs through the FEI Entry System for all categories of this Event (<https://invitation.fei.org/login>);
- Additional documentation can be found at: <https://inside.fei.org/fei/your-role/it-services/fei-entry-system/fei-entry-system-jumping>;
- All Athletes and Horses participating in any International Competition must be registered with the FEI;
- Athletes and/or Horses present at the Event without having been entered through the FEI's Online Entry System will be automatically disqualified unless compelling circumstances warrant otherwise.

Attention riders: during show please make your entries to competition next day before 6p.m. (every day). All information will be available in the show office.

1. ENTRY DATES AND ENTRY FEES

Entries have to be in accordance with Art.251 of the FEI Jumping Rules, 26th edition, updates effective 1 January 2020

Deadlines for Entries:

Definite Entries:

1st week 30/09/2021

2nd week 07/10/2021

Last date for substitutions:

**1st week 20.10.2021 1 hour before Horse
Inspection**

**2nd week 27.10.2021 1 hour before Horse
Inspection**

Entry fee per horse (per category):

VAT excluded

CSI 2*	400 EUR per week
CSI 1*	400 EUR per week
CSI YH	300 EUR per week

VAT (in %) :

Please refer to definition of Entry fees and Compulsory fees in the Glossary of the FEI Jumping Rules 26th edition, updates effective 1 January 2020, that is copied in Section XIV point 10.

Compulsory fees per horse:

- EADCMP Fee: Included in entry fee
Not included in entry fee

Lower Level Events (CIMs) CHF 18 per horse per event
Higher Level Events CHF 25 per horse per event
(For definition of CIMs see Appendix E of the FEI General Regulations, all other events not defined as CIMs)

- Fee for manure disposal (at OC discretion; maximum € 40 per horse per Event). 40 EUR per week, 60EUR per 2 weeks Per horse
- Fee for health/customs-related documents for Horses, if applicable (only if requested) 30euro Per horse

All aforementioned amounts are including VAT

Total maximum fee per horse: 70 EUR/50EUR +18 CHF per week

Compulsory fees per athlete:

- NF fee if applicable n/a Per athlete
- NF medication control programme fee if applicable n/a Per athlete
- Fee for lorry parking if applicable n/a Per lorry/caravan
- Fee for electric hook-up for lorry 80 EUR per week Per lorry/caravan

All aforementioned amounts are including VAT

Total maximum fee per Athlete: 80 EUR per hook-up per week

2. OTHER FEES

All other fees must optional fees and be listed hereunder with the details of the amounts to be charged and approved by the FEI. Only fees approved by the FEI and listed in the approved Schedule can be charged by the OC. *Please specify if price per bale or other quantity.*

Hay: 6 EUR per bail

Straw: 6 EUR bail (first bedding free)

Shavings: 12 EUR

Other (please specify):

permanent box with water bowl: 50 EUR (if available)

tack box: 200 EUR

box for horse not taking part: 250 EUR

Standard bedding in boxes straw. If You require shavings please mention the fact with definite entries at the name of the horse. 1st bedding free of charge - 2 bales ONCE AT ARRIVAL.

If the horse leaves the stables between weeks and needs empty box with one more bedding please mention the fact in the show office till Sunday 24.10.2021 – extra cost 30 EUR.

All aforementioned amounts are including VAT

VAT number of the organiser: PL 513 01 888 55

Payments on the show ground has to be made by cash or bank transfer.
NO CREDIT OR DEBIT CARDS

3. NO-SHOWS/LATE WITHDRAWALS

NB: In the case of withdrawals after the date of definite entries or no-shows the athlete or the respective NF will be held liable to reimburse the OC for the actual financial loss incurred by the OC (i.e. stabling and hotel expenses) as a result of the late withdrawal or no-show.

Amount charged:

Withdrawal (from the FEI Entry System) before date of definite entries - 01.10.2020 - free of charge.

Withdrawal (from the FEI Entry System) after date of definite entries and before the date of last substitution - The Athlete or respective NF has to pay 250 EUR per horse.

Withdrawal (from the FEI Entry System) after the date of last substitution or no-shows the Athlete or respective NF has to pay full fee as mentioned below:

CSI 2* 400 EUR

CSI 1* 400 EUR

CSI YH 300 EUR

GENERAL INFORMATION

All Athletes are required to fill out the account details in the show office on the arrival
-accounts will only be made on company name if the required information will be filled out correctly before Friday every week

- all entry fees and additional fees to be paid in the show office till 24.10.2021 for horses taking part only 1st week and till 30.10.2021 for horses taking part 2nd or both weeks

Advanced Payment entry fee:

Advanced payments will be appreciated.

Stowarzyszenie Klub Sportowy Klub Jazdy Konnej Szary
ul. Krakowska 131
32-091 Michałowice

payment in PLN: 66 1500 1487 1214 8008 3948 0000

payment in EUR: PL32 1090 2590 0000 0001 3309 2539

VIII. TIMETABLE

Competitions must not start before 08:00 and must not finish after 23:00, unless prior approval is granted by the FEI.

As per Jumping Rules Annex VI: combined competitions are not permitted.

The scheduling of competitions must take into account mandatory maintenance breaks as follows. In principle, there should be one maintenance break for every 40 starters; at a minimum, it is compulsory to include one maintenance break in competitions with 50-99 starters after half of the starters have competed. Competitions with 100 starters or more must have three maintenance breaks. The start list must indicate when the maintenance break will take place (e.g. after N° 25).

1st week 21-24.10.2021

	Day	Date	Time
• Opening of stables	Wednesday	20.10	8.00
• Horse Inspection <i>All horses taking part at this Event must be present during the first horse inspection, unless unable to do so due to "force majeure"</i>	Wednesday	20.10	17.00-19.00
1st horse inspection for stallions id beside the time mentioned above also possible 16.40-17.00 and 19.00-19.20			
• Horse Re-Inspection	Thursday	21.10	7.00
• Opening times of warm-up indoor arena	Wednesday	20.10	13.00-16.00 19.45-21.00
• Opening times of main indoor arena	Wednesday	20.10	13.00-18.00

2nd week 28-31.10.2021

	Day	Date	Time
• Opening of stables	Wednesday	27.10	13.00
• Horse Inspection <i>All horses taking part at this Event must be present during the first horse inspection, unless unable to do so due to "force majeure"</i>	Wednesday	27.10	17.00-19.00
1st horse inspection for stallions id beside the time mentioned above also possible 16.40-17.00 and 19.00-19.20			
• Horse Re-Inspection	Thursday	28.10	7.00
• Opening times of warm-up indoor arena	Wednesday	27.10	13.00-16.00 19.45-21.00
• Opening times of main indoor arena	Wednesday	27.10	13.00-18.00

Competitions CSI 2*:	Day	Date	Time	Art	Prize Money
• Declaration of Starters	The day before each competition before 18:00				
Competition 1 - Gold Round Table A, against the clock, 135cm	Thursday	21.10	following	238.2.1	8 000 pln
Competition 2 - Diamond Round Two Phases Table A/A, 140cm	Thursday	21.10	following	274.1.5.3	9 000 pln
Competition 3 - Gold Round Two Phases Table A/A, 140 cm	Friday	22.10	following	274.1.5.3	8 000 pln
Competition 4 Diamond Round –LR Table A, against the clock, 145 cm	Friday	22.10	following	238.2.1	103 000 pln
Competition 5 - Gold Round Final Table A with jump-off, 140 cm, Final	Saturday	23.10	following	238.2.2	18 000 pln
Competition 6 Grand Prix – LR Table A with jump-off, 145 cm, Final	Sunday	24.10	following	238.2.2	103 000 pln
• Total Prize Money	249 000 pln				
• Prizes in Kind	n/a <i>Prizes in kind must be easily convertible into cash (GRs Art. 127).</i>				

Competitions CSI 1*	Day	Date	Time	Art	Prize Money
• Declaration of Starters	The day before each competition before 18:00				
Competition 7 - Small Round Table A, against the clock, 110 cm	Thursday	21.10	following	238.2.1	1 500 pln
Competition 8 - Medium Round Two Phases Table A/A ,120 cm	Thursday	21.10	following	274.1.5.3	1 900 pln
Competition 9 - Big Round Table A, against the clock, 130 cm	Thursday	21.10	following	238.2.1	3 500 pln
Competition 10 - Small Round Table A, against the clock, 110 cm	Friday	22.10	following	238.2.1	1 500 pln
Competition 11 - Small Round Final Table A, against the clock, 115 cm, Final	Saturday	23.10	following	238.2.1	2 000 pln
Competition 12 - Medium Round Table A, against the clock, 120 cm	Saturday	23.10	following	238.2.1	1 900 pln
Competition 13 - Big Round Table A, against the clock, 130 cm	Saturday	23.10	following	238.2.1	3 500 pln
Competition 14 - Medium Round Final Table A, against the clock, 125 cm, Final	Sunday	24.10	following	238.2.1	3 000 pln
Competition 15 - CSI 1*Grand Prix Table A with jump off, 135 cm, Final	Sunday	24.10	following	238.2.2	8 800 pln
• Total Prize Money	27 600 pln				
• Prizes in Kind	N/A				

Competitions CSI YH*	Day	Date	Time	Art	Prize Money
• Declaration of Starters	The day before each competition before 18:00				
Competition 16 - 5 yo Two Phases Special Table A/A, 115 cm	Thursday	21.10	8:00	274.2.5	1 900 pln
Competition 17 - 5 yo Table A, against the clock, 115 cm	Friday	22.10	8:00	238.2.1	1 900 pln
Competition 18 - 6/7 yo Two Phases Special Table A/A, 125/130 cm	Friday	22.10	following	274.2.5	3 800 pln
Competition 19 - 5 yo Final Two Phases Table A/A, 120 cm	Saturday	23.10	8:00	274.1.5.3	3 900 pln
Competition 20 - 6/7 yo Table A, against the clock, 125/130 cm	Saturday	23.10	following	238.2.1	3 900 pln
Competition 21 - 6/7 yo Final Two Phases Table A/A ,130/135 cm	Sunday	24.10	8:00	274.1.5.3	8 000 pln
• Total Prize Money	23 400 pln				
• Prizes in Kind	N/A				

2nd week 28-31.10.2021

Competitions CSI 2*:	Day	Date	Time	Art	Prize Money
• Declaration of Starters	The day before each competition before 18:00				
Competition 22 - Gold Round Table A, against the clock, 135 cm	Thursday	28.10	following	238.2.1	8 000 pln
Competition 23 - Diamond Round Two Phases Table A/A, 140 cm	Thursday	28.10	following	274.1.5.3	9 000 pln
Competition 24 - Gold Round Two Phases Table A/A ,140 cm	Friday	29.10	following	274.1.5.3	8 000 pln
Competition 25 - Diamond Round -LR Table A, against the clock, 145 cm	Friday	29.10	following	238.2.1	103 000 pln
Competition 26 - Gold Round Final Table A with jump-off,140 cm, Final	Saturday	30.10	following	238.2.2	18 000 pln
Competition 27 -Grand Prix - LR Table A with jump-off, 145 cm, Final	Sunday	31.10	following	238.2.2	103 000 pln
• Total Prize Money	249 000 pln				
• Prizes in Kind	n/a <i>Prizes in kind must be easily convertible into cash (GRs Art. 127).</i>				

Competitions CSI 1*	Day	Date	Time	Art.	Prize Money
• Declaration of Starters	The day before each competition before 18:00				
Competition 28 - Small Round Table A, against the clock, 110 cm	Thursday	28.10	following	238.2.1	1 500 pln
Competition 29 - Medium Round Two Phases Table A/A, 120 cm	Thursday	28.10	following	274.1.5.3	1 900 pln
Competition 30 - Big Round Table A, against the clock, 130 cm	Thursday	28.10	following	238.2.1	3 500 pln
Competition 31 - Small Round Table A, against the clock, 110 cm	Friday	29.10	following	238.2.1	1 500 pln
Competition 32 - Small Round Final Table A, against the clock, 115 cm, Final	Saturday	30.10	following	238.2.1	2 000 pln
Competition 33 - Medium Round Table A, against the clock, 120 cm	Saturday	30.10	following	238.2.1	1 900 pln
Competition 34 - Big Round Table A, against the clock, 130 cm	Saturday	30.10	following	238.2.1	3 500 pln
Competition 35 - Medium Round Final Table A, against the clock, 125 cm, Final	Sunday	31.10	following	238.2.1	3 000 pln
Competition 36 - CSI 1*Grand Prix Table A with jump off, 135 cm, Final	Sunday	31.10	following	238.2.2	8 800 pln
• Total Prize Money	27 600 pln				
• Prizes in Kind	N/A				

Competitions CSI YH*	Day	Date	Time	Art.	Prize Money
• Declaration of Starters	The day before each competition before 18:00				
Competition 37 - 5 yo Two Phases Special Table A/A ,115 cm	Thursday	28.10	8:00	274.2.5	1 900 pln
Competition 38 - 5 yo Table A, against the clock, 115 cm	Friday	29.10	8:00	238.2.1	1 900 pln
Competition 39 - 6/7 yo Two Phases Special Table A/A, 125/130 cm	Friday	29.10	following	274.2.5	3 800 pln
Competition 40 - 5 yo Final Two Phases Table A/A, 120 cm	Saturday	30.10	8:00	274.1.5.3	3 900 pln
Competition 41 - 6/7 yo Table A, against the clock, 125/130 cm	Saturday	30.10	following	238.2.1	3 900 pln
Competition 42 - 6/7 yo Final Two Phases Table A/A, 130/135 cm	Sunday	31.10	8:00	274.1.5.3	8 000 pln
• Total Prize Money	23 400 pln				
• Prizes in Kind	N/A				

Overall prize money

- 1st week : 300 000 pln
- 2nd week : 300 000 pln

Applicable government tax to be deducted from Prize Money (see also XIV.8): **10%**

IX. COMPETITION DETAIL

1st week 21-24.10.2021

FIRST DAY : Thursday

DATE : 21.10.2021

COMPETITION No: 16

Time: 8:00

Type of Competition: Two Phases Special Table A/A
Competition description: **CSI YH* 5 years old**

Acc. to Article: 274.2.5

Jump-off (if any) no
Speed/Fixed time 350 m/min
Height of obstacles: 115 cm
Number of horses per athlete 2
Number of Starters: 100* (if more than 100 take part then please refer to Section XIV point 9)
Total prize money: 1900pln
Chart to be used: 1 (25% to winner)
2 (33% to winner)

Please specify prize money amount for each athlete placed 13th and beyond: 20pln

* * * * *

COMPETITION No: 7

Time: following

Type of Competition: Table A against the clock
Competition description: **CSI 1* Small Round**

Acc. to Article: 238.2.1

Jump-off (if any) no
Speed/Fixed time 350 m/min
Height of obstacles: 110 cm
Number of horses per athlete 2
Number of Starters: 100* (if more than 100 take part then please refer to Section XIV point 9)
Total prize money: 1500pln
Chart to be used: 1 (25% to winner)
2 (33% to winner)

Please specify prize money amount for each athlete placed 13th and beyond: 20pln

* * * * *

COMPETITION No: 8

Time: following

Type of Competition: Two Phases Table A/A
Competition description: **CSI 1* Medium Round**

Acc. to Article: 274.1.5.3

Jump-off (if any) no
Speed/Fixed time 350 m/min
Height of obstacles: 120 cm
Number of horses per athlete 2
Number of Starters: 100* (if more than 100 take part then please refer to Section XIV point 9)

Total prize money: 1900pln
Chart to be used: 1 (25% to winner)
2 (33% to winner)

Please specify prize money amount for each athlete placed 13th and beyond: 20pln

* * * * *

COMPETITION No: 9

Time: following

Type of Competition: Table A against the clock
Competition description: **CSI 1* Big Round**

Acc. to Article: 238.2.1

Jump-off (if any) no
Speed/Fixed time 350 m/min
Height of obstacles: 130 cm
Number of horses per athlete 2
Number of Starters: 100* (if more than 100 take part then please refer to Section XIV point 9)
Total prize money: 3500pln
Chart to be used: 1 (25% to winner)
2 (33% to winner)

Please specify prize money amount for each athlete placed 13th and beyond: 35pln

* * * * *

COMPETITION No: 1

Time: following

Type of Competition: Table A against the clock
Competition description: **CSI 2* Gold Round**

Acc. to Article: 238.2.1

Jump-off (if any) no
Speed/Fixed time 350 m/min
Height of obstacles: 135 cm
Number of horses per athlete 2
Number of Starters: 100* (if more than 100 take part then please refer to Section XIV point 9)
Total prize money: 8000pln
Chart to be used: 1 (25% to winner)
2 (33% to winner)

Please specify prize money amount for each athlete placed 13th and beyond: 80pln

* * * * *

COMPETITION No: 2

Time: following

Type of Competition: Two phases Table A/A
Competition description: **CSI 2* Diamond Round**

Acc. to Article: 274.1.5.3

- Qualifier for competition no. 6 Grand Prix - LR

Jump-off (if any) no
Speed/Fixed time 350 m/min

FEI APPROVED SCHEDULE
Michalowice 21-31 October 2021



Height of obstacles: 140 cm
Number of horses per athlete 2
Number of Starters: 100* (if more than 100 take part then please refer to Section XIV point 9)
Total prize money: 9000pln
Chart to be used: 1 (25% to winner)
2 (33% to winner)
Please specify prize money amount for each athlete placed 13th and beyond: 100pln

SECOND DAY : Friday

DATE : 22.10.2021

COMPETITION No: 17

Time: 8:00

Type of Competition: Table A against the clock Acc. to Article: 238.2.1
Competition description: **CSI YH* 5 years old**

Jump-off (if any) no
Speed/Fixed time 350 m/min
Height of obstacles: 115 cm
Number of horses per athlete 2
Number of Starters: 100* (if more than 100 take part then please refer to Section XIV point 9)
Total prize money: 1900pln
Chart to be used: 1 (25% to winner)
2 (33% to winner)
Please specify prize money amount for each athlete placed 13th and beyond: 20pln

* * * * *

COMPETITION No: 18

Time: following

Type of Competition: Two Phases Special Table A/A Acc. to Article: 274.2.5
Competition description: **CSI YH* 6 and 7 years old**

Jump-off (if any) no
Speed/Fixed time 350 m/min
Height of obstacles: 125 cm - 6yo/1.30m - 7yo
Number of horses per athlete 4 (max. 2 per age)
Number of Starters: 100* (if more than 100 take part then please refer to Section XIV point 9)
Total prize money: 3800pln
Chart to be used: 1 (25% to winner)
2 (33% to winner)
Please specify prize money amount for each athlete placed 13th and beyond: 40pln

* * * * *

COMPETITION No: 10

Time: following

Type of Competition: Table A against the clock Acc. to Article: 238.2.1
Competition description: **CSI 1* Small Round**

Jump-off (if any) no
Speed/Fixed time 350 m/min

FEI APPROVED SCHEDULE
Michalowice 21-31 October 2021



Height of obstacles: 110 cm
Number of horses per athlete 2
Number of Starters: 100* (if more than 100 take part then please refer to Section XIV point 9)
Total prize money: 1500pln
Chart to be used: 1 (25% to winner)
2 (33% to winner)
Please specify prize money amount for each athlete placed 13th and beyond: 20pln

* * * * *

COMPETITION No: 3

Time: following

Type of Competition: Two phases Table A/A Acc. to Article: 274.1.5.3
Competition description: **CSI 2* Gold Round**

Jump-off (if any) no
Speed/Fixed time 350 m/min
Height of obstacles: 140 cm
Number of horses per athlete 2
Number of Starters: 100* (if more than 100 take part then please refer to Section XIV point 9)
Total prize money: 8000pln
Chart to be used: 1 (25% to winner)
2 (33% to winner)
Please specify prize money amount for each athlete placed 13th and beyond: 80pln

* * * * *

COMPETITION No: 4

Time: following

Type of Competition: Table A, against the clock, Acc. to Article: 238.2.1
Competition description: **CSI 2* Diamond Round - LR**

- This competition will count for the Longines Ranking Group D
- Qualifier for competition no. 6 Grand Prix - LR
- Horses competing in this competition are not allowed to compete in competition no 5 Gold Round Final

Jump-off (if any) no
Speed/Fixed time 350 m/min
Height of obstacles: 145 cm
Number of horses per athlete 1
Number of Starters: 80
Total prize money: 103 000pln
Chart to be used: 1 (25% to winner)
2 (33% to winner)
Please specify prize money amount for each athlete placed 13th and beyond: 200pln

THIRD DAY : Saturday

DATE : 23.10.2021

COMPETITION No: 19

Time: 8:00

Type of Competition: Two Phases Table A/A

Acc. to Article: 274.1.5.3

Competition description: **CSI YH* 5 years old Final**

Jump-off (if any) no
Speed/Fixed time 350 m/min
Height of obstacles: 120 cm
Number of horses per athlete 2
Number of Starters: 100* (if more than 100 take part then please refer to Section XIV point 9)
Total prize money: 3900pln
Chart to be used: 1 (25% to winner)
2 (33% to winner)

Please specify prize money amount for each athlete placed 13th and beyond: 40pln

* * * * *

COMPETITION No: 20

Time: following

Type of Competition: Table A, against the clock,

Acc. to Article: 238.2.1

Competition description: **CSI YH* 6 and 7 years old**

Jump-off (if any) no
Speed/Fixed time 350 m/min
Height of obstacles: 125 cm - 6yo/ 130 cm - 7yo
Number of horses per athlete 4 (max. 2 per age)
Number of Starters: 100* (if more than 100 take part then please refer to Section XIV point 9)
Total prize money: 3900pln
Chart to be used: 1 (25% to winner)
2 (33% to winner)

Please specify prize money amount for each athlete placed 13th and beyond: 40pln

* * * * *

COMPETITION No: 11

Time: following

Type of Competition: Table A, against the clock,

Acc. to Article: 238.2.1

Competition description: **CSI 1* Small Round Final**

Jump-off (if any) no
Speed/Fixed time 350 m/min
Height of obstacles: 115 cm
Number of horses per athlete 2
Number of Starters: 100* (if more than 100 take part then please refer to Section XIV point 9)
Total prize money: 2000pln
Chart to be used: 1 (25% to winner)
2 (33% to winner)

Please specify prize money amount for each athlete placed 13th and beyond: 20pln

* * * * *

COMPETITION No: 12

Time: following

Type of Competition: Table A, against the clock,
Competition description: **CSI 1* Medium Round**

Acc. to Article: 238.2.1

Jump-off (if any) no
Speed/Fixed time 350 m/min
Height of obstacles: 120 cm
Number of horses per athlete 2
Number of Starters: 100* (if more than 100 take part then please refer to Section XIV point 9)
Total prize money: 1900pln
Chart to be used: 1 (25% to winner)
2 (33% to winner)

Please specify prize money amount for each athlete placed 13th and beyond: 20pln

* * * * *

COMPETITION No: 13

Time: following

Type of Competition: Table A, against the clock,
Competition description: **CSI 1* Big Round**

Acc. to Article: 238.2.1

Jump-off (if any) no
Speed/Fixed time 350 m/min
Height of obstacles: 130 cm
Number of horses per athlete 2
Number of Starters: 100* (if more than 100 take part then please refer to Section XIV point 9)
Total prize money: 3500pln
Chart to be used: 1 (25% to winner)
2 (33% to winner)

Please specify prize money amount for each athlete placed 13th and beyond: 35pln

* * * * *

COMPETITION No: 5

Time: following

Type of Competition: Table A with Jump off
Competition description: **CSI 2* - Gold Round Final**

Acc. to Article: 238.2.2

Jump-off (if any) yes
Speed/Fixed time 350 m/min
Height of obstacles: 140 cm
Number of horses per athlete 2
Number of Starters: 100* (if more than 100 take part then please refer to Section XIV point 9)
Total prize money: 18 000pln
Chart to be used: 1 (25% to winner)
2 (33% to winner)

Please specify prize money amount for each athlete placed 13th and beyond: 100pln

FOURTH DAY : Sunday

DATE : 24.10.2021

COMPETITION No: 21

Time: 8:00

Type of Competition: Two Phases Table A/A Acc. to Article: 274.1.5.3
Competition description: **CSI YH* 6 and 7 years old Final**

Jump-off (if any) no
Speed/Fixed time 350 m/min
Height of obstacles: 130 cm - 6yo/ 135 cm - 7yo
Number of horses per athlete 4 (max. 2per age)
Number of Starters: 100* (if more than 100 take part then please refer
to Section XIV point 9)
Total prize money: 8000pln
Chart to be used: 1 (25% to winner)
2 (33% to winner)

Please specify prize money amount for each athlete placed 13th and beyond: 80pln

* * * * *

COMPETITION No: 14

Time: following

Type of Competition: Table A, against the clock, Acc. to Article: 238.2.1
Competition description: **CSI 1* Medium Round Final**

Jump-off (if any) no
Speed/Fixed time 350 m/min
Height of obstacles: 125 cm
Number of horses per athlete 2
Number of Starters: 100* (if more than 100 take part then please refer
to Section XIV point 9)
Total prize money: 3000pln
Chart to be used: 1 (25% to winner)
2 (33% to winner)

Please specify prize money amount for each athlete placed 13th and beyond: 30pln

* * * * *

COMPETITION No: 15

Time: following

Type of Competition: Table A with jump off Acc. to Article: 238.2.2
Competition description: **Big Round - CSI 1* Grand Prix**

The best 40 athletes from competition no. 9 will be qualified for this competition and the rest from competition no 13 to fulfil the number of 100 starters including prequalified athletes. If the number of participants is still less than 100, the next riders from class no 9 (or next from class no 13 if necessary) can compete in CSI1* Grand Prix, provided her/his entries will not exceed quota 100.

Jump-off (if any) yes
Speed/Fixed time 350 m/min
Height of obstacles: 135 cm
Number of horses per athlete 1 (2 acc. to 254.6, if 50 starters or less)
Number of Starters: 100

Total prize money: 8800pln
Chart to be used: 1 (25% to winner)
2 (33% to winner)

Please specify prize money amount for each athlete placed 13th and beyond: 80pln

The following Athletes are pre-qualified for the Grand Prix if present:

- the winner of that Event's Grand Prix the previous year
- the current National Jumping Champion of the host country
- the individual Jumping medal winners of the last Olympic and Pan-American Games, the last FEI World and FEI Continental Championships and the winner of the last FEI World Cup Final

The following Athletes are pre-qualified for the Grand Prix if present:

All athletes qualified for the Grand Prix, including those automatically qualified must complete, with their Grand Prix horse, the initial round of at least one FEI competition among those listed in JRs Art. 261.4.4 prior to the Grand Prix.

* * * * *

COMPETITION No: 6

Time: following

Type of Competition: Table A with Jump off Acc. to Article: 238.2.2

Competition description: **CSI 2* - GRAND PRIX - LR**

- This competition will count for the Longines Ranking Group D
- The best 40 athletes from competition no. 4 will be qualified for this competition and the rest from competition no 2 to fulfil the number of 80 starters. If the number of participants is still less than 80, the next riders from class no 4 (or next from class no 2 if necessary) can compete in CSI2* Grand Prix.
- All Athletes qualified for the CSI2* Grand Prix must confirm their participation before Saturday 17.10.2020 18:00 hrs. If Athlete doesn't confirm her/his participation the next Athlete from competitions as described above will be qualified.
- Horses competing in this competition are not allowed to compete in competition no 5 Gold Round Final

Jump-off (if any) yes
Speed/Fixed time 350 m/min
Height of obstacles: 145 cm
Number of horses per athlete 1 (2 acc. to 254.6, if 40 starters or less)
Number of Starters: 80
Total prize money: 103 000pln
Chart to be used: 1 (25% to winner)
2 (33% to winner)

Please specify prize money amount for each athlete placed 13th and beyond: 200pln

The following Athletes are pre-qualified for the Grand Prix if present:

- the winner of that Event's Grand Prix the previous year
- the current National Jumping Champion of the host country
- the individual Jumping medal winners of the last Olympic and Pan-American Games, the last FEI World and FEI Continental Championships and the winner of the last FEI World Cup Final

The following Athletes are pre-qualified for the Grand Prix if present:

All athletes qualified for the Grand Prix, including those automatically qualified must

complete, with their Grand Prix horse, the initial round of at least one FEI competition among those listed in JRs Art. 261.4.4 prior to the Grand Prix.

* * * * *

2nd week 28-31.10.2021

FIRST DAY : Thursday

DATE : 28.10.2021

COMPETITION No: 37

Time: 8:00

Type of Competition: Two Phases Special Table A/A

Acc. to Article: 274.2.5

Competition description: **CSI YH* 5 years old**

Jump-off (if any) no
Speed/Fixed time 350 m/min
Height of obstacles: 115 cm
Number of horses per athlete 2
Number of Starters: 100* (if more than 100 take part then please refer to Section XIV point 9)
Total prize money: 1900pln
Chart to be used: 1 (25% to winner)
2 (33% to winner)

Please specify prize money amount for each athlete placed 13th and beyond: 20pln

* * * * *

COMPETITION No: 28

Time: following

Type of Competition: Table A, against the clock,

Acc. to Article: 238.2.1

Competition description: **CSI 1* Small Round**

Jump-off (if any) no
Speed/Fixed time 350 m/min
Height of obstacles: 110 cm
Number of horses per athlete 2
Number of Starters: 100* (if more than 100 take part then please refer to Section XIV point 9)
Total prize money: 1500pln
Chart to be used: 1 (25% to winner)
2 (33% to winner)

Please specify prize money amount for each athlete placed 13th and beyond: 20pln

* * * * *

COMPETITION No: 29

Time: following

Type of Competition: Two Phases Table A/A

Acc. to Article: 274.1.5.3

Competition description: **CSI 1* Medium Round**

Jump-off (if any) no
Speed/Fixed time 350 m/min
Height of obstacles: 120 cm
Number of horses per athlete 2
Number of Starters: 100* (if more than 100 take part then please refer to Section XIV point 9)

FEI APPROVED SCHEDULE
Michalowice 21-31 October 2021



Total prize money: 1900pln
Chart to be used: 1 (25% to winner)
2 (33% to winner)

Please specify prize money amount for each athlete placed 13th and beyond: 20pln
COMPETITION No: 30 **Time:** following

Type of Competition: Table A, against the clock, Acc. to Article: 238.2.1
Competition description: **CSI 1* Big Round**

Jump-off (if any) no
Speed/Fixed time 350 m/min
Height of obstacles: 130 cm
Number of horses per athlete 2
Number of Starters: 100* (if more than 100 take part then please refer
to Section XIV point 9)
Total prize money: 3500pln
Chart to be used: 1 (25% to winner)
2 (33% to winner)

Please specify prize money amount for each athlete placed 13th and beyond: 35pln

* * * * *

COMPETITION No: 22 **Time:** following

Type of Competition: Table A, against the clock, Acc. to Article: 238.2.1
Competition description: **CSI 2* Gold Round**

Jump-off (if any) no
Speed/Fixed time 350 m/min
Height of obstacles: 135 cm
Number of horses per athlete 2
Number of Starters: 100* (if more than 100 take part then please refer
to Section XIV point 9)
Total prize money: 8000pln
Chart to be used: 1 (25% to winner)
2 (33% to winner)

Please specify prize money amount for each athlete placed 13th and beyond: 80pln

* * * * *

COMPETITION No: 23 **Time:** following

Type of Competition: Two phases Table A/A Acc. to Article: 274.1.5.3
Competition description: **CSI 2* Diamond Round**

- Qualifier for competition no. 27 Grand Prix - LR

Jump-off (if any) no
Speed/Fixed time 350 m/min
Height of obstacles: 140 cm
Number of horses per athlete 2
Number of Starters: 100* (if more than 100 take part then please refer
to Section XIV point 9)
Total prize money: 9000pln

FEI APPROVED SCHEDULE
Michalowice 21-31 October 2021



Chart to be used: 1 (25% to winner)
2 (33% to winner)

Please specify prize money amount for each athlete placed 13th and beyond: 100pln

SECOND DAY : Friday **DATE : 29.10.2021**

COMPETITION No: 38

Time: 8:00

Type of Competition: Table A, against the clock,
Competition description: **CSI YH* 5 years old**

Acc. to Article: 238.2.1

Jump-off (if any) no
Speed/Fixed time 350 m/min
Height of obstacles: 115 cm
Number of horses per athlete 2
Number of Starters: 100* (if more than 100 take part then please refer
to Section XIV point 9)
Total prize money: 1900pln
Chart to be used: 1 (25% to winner)
2 (33% to winner)

Please specify prize money amount for each athlete placed 13th and beyond: 20pln

* * * * *

COMPETITION No: 39

Time: following

Type of Competition: Two Phases Special Table A/A
Competition description: **CSI YH* 6 and 7 years old**

Acc. to Article: 274.2.5

Jump-off (if any) no
Speed/Fixed time 350 m/min
Height of obstacles: 125 cm - 6yo/1.30m - 7yo
Number of horses per athlete 4 (max. 2 per age)
Number of Starters: 100* (if more than 100 take part then please refer
to Section XIV point 9)
Total prize money: 3800pln
Chart to be used: 1 (25% to winner)
2 (33% to winner)

Please specify prize money amount for each athlete placed 13th and beyond: 40pln

* * * * *

COMPETITION No: 31

Time: following

Type of Competition: Table A, against the clock,
Competition description: **CSI 1* Small Round**

Acc. to Article: 238.2.1

Jump-off (if any) no
Speed/Fixed time 350 m/min
Height of obstacles: 110 cm
Number of horses per athlete 2
Number of Starters: 100* (if more than 100 take part then please refer
to Section XIV point 9)
Total prize money: 1500pln
Chart to be used: 1 (25% to winner)

2 (33% to winner)

Please specify prize money amount for each athlete placed 13th and beyond: 20pIn

* * * * *

COMPETITION No: 24

Time: following

Type of Competition: Two phases Table A/A

Acc. to Article: 274.1.5.3

Competition description: **CSI2* Gold Round**

Jump-off (if any) no
Speed/Fixed time 350 m/min
Height of obstacles: 140 cm
Number of horses per athlete 2
Number of Starters: 100* (if more than 100 take part then please refer to Section XIV point 9)
Total prize money: 8000pIn
Chart to be used: 1 (25% to winner)
2 (33% to winner)

Please specify prize money amount for each athlete placed 13th and beyond: 80pIn

* * * * *

COMPETITION No: 25

Time: following

Type of Competition: Table A, against the clock,

Acc. to Article: 238.2.1

Competition description: **CSI2* Diamond Round - LR**

- This competition will count for the Longines Ranking Group D
- Qualifier for competition no. 27 Grand Prix - LR

Jump-off (if any) no
Speed/Fixed time 350 m/min
Height of obstacles: 145 cm
Number of horses per athlete 1
Number of Starters: 80
Total prize money: 103 000pIn
Chart to be used: 1 (25% to winner)
2 (33% to winner)

Please specify prize money amount for each athlete placed 13th and beyond: 200pIn

THIRD DAY : Saturday

DATE : 30.10.2021

COMPETITION No: 40

Time: 8:00

Type of Competition: Two Phases Table A/A

Acc. to Article: 274.1.5.3

Competition description: **CSI YH* 5 years old Final**

Jump-off (if any) no
Speed/Fixed time 350 m/min
Height of obstacles: 120 cm

Number of horses per athlete 2
Number of Starters: 100* (if more than 100 take part then please refer to Section XIV point 9)
Total prize money: 3900pln
Chart to be used: 1 (25% to winner)
2 (33% to winner)
Please specify prize money amount for each athlete placed 13th and beyond: 40pln

* * * * *

COMPETITION No: 41

Time: following

Type of Competition: Table A, against the clock, Acc. to Article: 238.2.1
Competition description: **CSI YH* 6 and 7 years old**

Jump-off (if any) no
Speed/Fixed time 350 m/min
Height of obstacles: 125 cm - 6yo/ 130 cm - 7yo
Number of horses per athlete 4 (max. 2 per age)
Number of Starters: 100* (if more than 100 take part then please refer to Section XIV point 9)
Total prize money: 3900pln
Chart to be used: 1 (25% to winner)
2 (33% to winner)
Please specify prize money amount for each athlete placed 13th and beyond: 40pln

* * * * *

COMPETITION No: 32

Time: following

Type of Competition: Table A, against the clock, Acc. to Article: 238.2.1
Competition description: **CSI 1* Small Round Final**

Jump-off (if any) no
Speed/Fixed time 350 m/min
Height of obstacles: 115 cm
Number of horses per athlete 2
Number of Starters: 100* (if more than 100 take part then please refer to Section XIV point 9)
Total prize money: 2000pln
Chart to be used: 1 (25% to winner)
2 (33% to winner)
Please specify prize money amount for each athlete placed 13th and beyond: 20pln

* * * * *

COMPETITION No: 33

Time: following

Type of Competition: Table A, against the clock, Acc. to Article: 238.2.1
Competition description: **CSI 1* Medium Round**

Jump-off (if any) no
Speed/Fixed time 350 m/min
Height of obstacles: 120 cm
Number of horses per athlete 2

Number of Starters: 100* (if more than 100 take part then please refer to Section XIV point 9)
Total prize money: 1900pln
Chart to be used: 1 (25% to winner)
2 (33% to winner)
Please specify prize money amount for each athlete placed 13th and beyond: 20pln

* * * * *

COMPETITION No: 34

Time: following

Type of Competition: Table A, against the clock, Acc. to Article: 238.2.1
Competition description: **CSI 1* Big Round**

Jump-off (if any) no
Speed/Fixed time 350 m/min
Height of obstacles: 130 cm
Number of horses per athlete 2
Number of Starters: 100* (if more than 100 take part then please refer to Section XIV point 9)
Total prize money: 3500pln
Chart to be used: 1 (25% to winner)
2 (33% to winner)
Please specify prize money amount for each athlete placed 13th and beyond: 35pln

* * * * *

COMPETITION No: 26

Time: following

Type of Competition: Table A with Jump off Acc. to Article: 238.2.2
Competition description: **CSI 2* - Gold Round Final**

Jump-off (if any) yes
Speed/Fixed time 350 m/min
Height of obstacles: 140 cm
Number of horses per athlete 2
Number of Starters: 100* (if more than 100 take part then please refer to Section XIV point 9)
Total prize money: 18000pln
Chart to be used: 1 (25% to winner)
2 (33% to winner)
Please specify prize money amount for each athlete placed 13th and beyond: 100pln

FOURTH DAY : Sunday

DATE : 31.10.2021

COMPETITION No: 42

Time: 8:00

Type of Competition: Two Phases Table A/A Acc. to Article: 274.1.5.3
Competition description: **CSI YH* 6 and 7 years old Final**

Jump-off (if any) no

Speed/Fixed time 350 m/min
Height of obstacles: 130 cm - 6yo/ 135 cm - 7yo
Number of horses per athlete 4 (max. 2per age)
Number of Starters: 100* (if more than 100 take part then please refer to Section XIV point 9)
Total prize money: 8000pln
Chart to be used: 1 (25% to winner)
2 (33% to winner)
Please specify prize money amount for each athlete placed 13th and beyond: 80pln

* * * * *

COMPETITION No: 35

Time: following

Type of Competition: Table A, against the clock, Acc. to Article: 238.2.1
Competition description: **CSI 1* Medium Round Final**

Jump-off (if any) no
Speed/Fixed time 350 m/min
Height of obstacles: 125 cm
Number of horses per athlete 2
Number of Starters: 100* (if more than 100 take part then please refer to Section XIV point 9)
Total prize money: 3000pln
Chart to be used: 1 (25% to winner)
2 (33% to winner)
Please specify prize money amount for each athlete placed 13th and beyond: 30pln

* * * * *

COMPETITION No: 36

Time: following

Type of Competition: Table A with jump off Acc. to Article: 238.2.2
Competition description: **Big Round - CSI 1- * Grand Prix**

The best 40 athletes from competition no. 30 will be qualified for this competition and the rest from competition no 34 to fulfil the number of 100 starters. If the number of participants is still less than 100, the next riders from class no 30 (or next from class no 34 if necessary) can compete in CSI1* Grand Prix, provided her/his entries will not exceed quota 100.

Jump-off (if any) yes
Speed/Fixed time 350 m/min
Height of obstacles: 135 cm
Number of horses per athlete 1 (**2 acc. to 254.6, if 50 starters or less**)
Number of Starters: 100
Total prize money: 8800pln
Chart to be used: 1 (25% to winner)
2 (33% to winner)
Please specify prize money amount for each athlete placed 13th and beyond: 80pln

The following Athletes are pre-qualified for the Grand Prix if present:
- the winner of that Event's Grand Prix the previous year
- the current National Jumping Champion of the host country

- the individual Jumping medal winners of the last Olympic and Pan-American Games, the last FEI World and FEI Continental Championships and the winner of the last FEI World Cup Final

All athletes qualified for the Grand Prix, including those automatically qualified must complete, with their Grand Prix horse, the initial round of at least one FEI competition among those listed in JRs Art. 261.4.4 prior to the Grand Prix.

* * * * *

COMPETITION No: 27

Time: following

Type of Competition: Table A with Jump off

Acc. to Article: 238.2.2

Competition description: **CSI2* - GRAND PRIX - LR**

- This competition will count for the Longines Ranking Group D
- The best 40 athletes from competition no. 25 will be qualified for this competition and the rest from competition no 23 to fulfil the number of 80 starters. If the number of participants is still less than 80 the next riders from class no 25 (or next from class no 23 if necessary) can compete in CSI2* Grand Prix.
- All Athletes qualified for the CSI2* Grand Prix must confirm their participation before Saturday 24.10.2020 18:00 hrs. If Athlete doesn't confirm her/his participation the next Athlete from competitions as described above will be qualified.
- Horses competing in this competition are not allowed to compete in competition no 26 Gold Round Final

Jump-off (if any)	yes
Speed/Fixed time	350 m/min
Height of obstacles:	145 cm
Number of horses per athlete	1 (2 acc. to 254.6, if 40 starters or less)
Number of Starters:	80
Total prize money:	103 000pln
Chart to be used:	1 (25% to winner) <input checked="" type="checkbox"/>
	2 (33% to winner) <input type="checkbox"/>

Please specify prize money amount for each athlete placed 13th and beyond: 200pln

- The following Athletes are pre-qualified for the Grand Prix if present:
 - the winner of that Event's Grand Prix the previous year
 - the current National Jumping Champion of the host country
 - the individual Jumping medal winners of the last Olympic and Pan-American Games, the last FEI World and FEI Continental Championships and the winner of the last FEI World Cup Final

All athletes qualified for the Grand Prix, including those automatically qualified must complete, with their Grand Prix horse, the initial round of at least one FEI competition among those listed in JRs Art. 261.4.4 prior to the Grand Prix.

X. FACILITIES OFFERED

1. ATHLETES

Accommodation

Hotel: Szary Residence AT THE SHOW GROUND

Address: ul. Parkurowa 1; 32-091 Michałowice

Telephone: +48 12 306 51 00

At the expense of: The Organiser or Athletes

Accommodated (bed and breakfast) from _____ to _____

Meals

At the expense of: The Organiser or Athletes

Meals provided from 7:00 to 22:00 .

2. GROOMS

Accommodation.

Requests for accommodation must be sent with entries.

At the expense of: The Organiser or Athletes

Accommodated (bed and breakfast) from _____ to _____

Meals.

At the expense of: The Organiser or Athletes

Meals provided from _____ to _____ .

NB: If applicable, Organiser must provide proper sanitary conditions. The showering facilities should be sufficient for both male and female grooms with hot and cold water. Shower facilities as well as restrooms should at all times be in a state of cleanliness.

XI. LOGISTICAL/ADMINISTRATIVE/TECHNICAL INFORMATION

1. DRAW

List of Draws, time, date and location:

Starting order in Grand Prix according to draw made by computer, day before GP at 21.00 in the show office

2. COMPETITION ARENA(S)

Dimensions: indoor 30x66m
Type of Footing: quartz sand

3. PRACTICE ARENA(S)

Dimensions: indoor 23x48m
Type of Footing: quartz sand

Dimensions outdoor arena: 55x80m
Type of Footing: quartz sand

Riders must have the possibility to exercise their horses in an exercise area under a Steward's supervision at least 30 minutes per day outside of the competition warm-up period. Details of opening times of exercise areas must be included in the timetable.

4. STABLES

Size of boxes 3 m x 3 m (minimum 3m x 3m+20% 3m x 4m)

Stables for competing horses available in tents or permanent box with water bowls (extra cost 50 EUR per box per week) - limited number.

5. SAFETY CUPS

Name of Manufacturer: Beck + Heun GmbH

6. TIMING DEVICE

Name of Manufacturer: Tag Heuer
Model: PTB 606
FEI Report number: 220100001A

7. SCORING/TIMING PROVIDER

Will you use a FEI Certified Service Provider to manage the scoring and timing at your Event?

(The list of certified Service Providers is available here: <https://inside.fei.org/fei/your-role/it-services/it-providers/list>)

No

Name of the company: Tarant Events

FEI Certified Service Provider ID number:

Contact person at Event

Name: Agnieszka Tarant
FEI ID number: 10139344
Contact email: office@tarantevents.pl

The FEI may require to be provided with real time results data feed of your events according to FEI requirements; in this case you and your provider will be informed accordingly.

8. OTHER TECHNOLOGY/SERVICE PROVIDER(S)

Will you use other technology/service provider(s) at your event?

No

9. PRIZE GIVING CEREMONY

The owner of the winning horse/pony must be invited to the prize giving ceremony for the Grand Prix, if present at the event.

The number of athletes required to present themselves for the prize-giving ceremony of each competition is

CSI1* CSI YH : 6

CSI2* 8..

10. ADVERTISING ON ATHLETES AND HORSES

At CSI events, and all competitions except for the Nations Cup, athletes are authorised to carry the logo of their personal sponsor in accordance with the articles 256.3 and 257.3 of the FEI Jumping Rules.

The Chief Steward will check that the advertising on athletes and horses complies with these Articles.

11. TICKETING

Are you selling tickets for spectators to attend your event: Yes No

Name of your ticketing provider:

Web address to buy ticket:

12. BETTING

Betting will be authorised by the Organiser: Yes No

13. TRANSPORT REIMBURSEMENT HORSES / PONIES

Transport expenses to be paid by:

The Organiser at _____ per km.

The Athlete

14. WELCOME

The time and date of arrival of athletes, horses and their means of transport must be given to the Organiser in order to facilitate their arrival.

15. LOCAL TRANSPORTATION - ARRANGEMENTS FROM HOTEL TO SHOWGROUNDS

Walking distance

Organiser Shuttle Service

Public Transport to be paid by the Organiser / the Athlete

If paid by Athlete approximate cost per round trip:

Other:

16. ENTRY RIGHT TO SHOWGROUNDS/ACCREDITED PERSONS

Entry right to the stable area according to FEI Veterinary Regulations Articles 1008-1009.

NUMBER OF ACCREDITED PERSONS:

Athlete: 1

Partner: 2

Groom: 1

Horse Owner: 2 two (2) accreditations per horse acc. to FEI-Passport

17. SUSTAINABILITY

Please consider the environment when organising an FEI Event. Please find useful information on FEI Sustainability here: <http://inside.fei.org/fei/your-role/organisers/handbook>

XII. VETERINARY MATTERS

1. CUSTOMS FORMALITIES

Contact details for Customs Formalities:

Name: C. Hartwing S.A. (national shipping company)
Address: Równoległa 4; 02-235 Warszawa
Telephone: +48 228683472
Fax: +48 228466996
Email: k.jaorsz@chg.pl
Opening hours: 8.00-16.00

2. HEALTH REQUIREMENTS

GENERAL

In accordance with the FEI Code of Conduct for the Welfare of the Horse it is imperative that all Horses at FEI Events are physically fit and free from infectious disease before being allowed to compete.

ENTRY OF HORSES

Required health tests and vaccinations:

Quarantine period:

Specimen Import Licence applied:

For questions or problems, please contact your Government Veterinary Services.

All horses entered for the CSI 1* CSI 2* must be 6 years old or more.
Horses taking participation in CSI 1*, CSI2* or CSI YH in their country of residence are not required to have FEI passport (FEI Grs art.137.2)
Not Competing Horses must be presented at the Horse inspection for the identification and vaccination control.

Under the law, all horses must have a health certificate - TRACES document. This certificate is issued by an official veterinarian. The rider is required to have a compulsory certificate per horse. Documents will be verified before and during the event. If the horse will not have a TRACES document - it will not be allowed into the competition area.

3. NATIONAL REQUIREMENTS

If applicable please provide:

Please refer to the website <http://www.viatoll.pl> for information referring to payment of a toll in Poland.

4. PONIES

FEI Veterinary Regulations, Chapter IX and Annex IX:

For all Pony Events, Ponies must be available for Pony Measurement if requested by the FEI.

5. INJURY SURVEILLANCE

FEI Veterinary Regulations, Chapter VIII:

Horses participating in FEI Events are subject to injury surveillance protocols; and in the event of fatality, a post mortem examination.

6. TRANSPORT OF HORSES

Horses must be fit to travel and be transported in suitable vehicles for the transport of horses. Any government requirements for disease testing and control must be requested well in advance, to ensure that the horse is in compliance by the time of arrival at the border of the country where the Event is taking place. Athletes, or their representatives, have the responsibility to comply with national legislation in both their country of origin and the host nation of the Event. Where necessary athletes must contact local government authorities or veterinary advisors for information regarding animal health requirements and transport legislation. Within the European Union (EU), this includes EU Council Regulation (EC) No 1/2005 concerning the protection of animals during transport within the Member States of the EU.

7. VENUE ARRIVAL INFORMATION & FITNESS TO COMPETE

7.1. PASSPORTS. FEI General Regulations Article 137

For all issues relating to FEI Horse Passports/FEI Recognition Cards please contact your National Federation.

All Horses competing at FEI Events must be registered with the FEI.

FEI Passports or FEI Recognition Cards (for those Horses with a national passport approved by the FEI) are compulsory for FEI Events.

NB: Horses entered in CIMs and in CSIP in their country of residence are not required to have an FEI Passport or FEI Recognition Card but must be properly registered with the FEI and identifiable (GRs 137.2).

Athletes who do not present a Horse’s Passport and/or Recognition Card, or one that is not correctly validated or fail to meet other passport requirements will be **subject to Sanctions in accordance with Annex VI of the FEI Veterinary Regulations** and may not be allowed to compete.

NB for Horses permanently resident in a Member State of the European Union: all Horses must have a national EU passport in compliance with EU Regulations to which a FEI Recognition card is applied. The exception to this being Horses in possession of an FEI passport which has been continually revalidated without interruption.

7.2. VACCINATIONS - EQUINE INFLUENZA. FEI Veterinary Regulations Article 1003

Horses competing at FEI Events must comply with the requirements for Equine Influenza vaccination in accordance with the Veterinary Regulations and as summarised below.

VACCINATION	PROTOCOL	ELIGIBILITY TO ENTER VENUE
Primary Course	1 st Vaccination: day 0 2 nd Vaccination: day 21-92	May compete 7 days after the 2 nd Vaccination
First Booster	Within 7 months of the 2 nd vaccination of the Primary Course	May compete for 6 months +21 days after the 2 nd vaccination of the Primary Course Must not compete in the 7 days

		after receiving a vaccination
Boosters	<p>MINIMUM: within one year of previous booster vaccination</p> <p>IF COMPETING: must be in the 6 months +21 days of the booster previous vaccination</p>	<p>Must have been vaccinated within 6 months +21 days before arriving at the Event</p> <p>Must not compete in the 7 days after receiving a vaccination</p>

All FEI registered Horses intending to compete at FEI Events (including CIMs) must be vaccinated against Equine Influenza in accordance with these VRs. The exception being if the applicable domestic legislation prevents the use of Equine Influenza vaccines within the relevant territory

7.3. EXAMINATION ON ARRIVAL. FEI Veterinary Regulations Article 1031

On arrival at an Event venue, all Horses must undergo an examination by a veterinarian to confirm their identification from their passport and micro-chip ID (where present), their vaccination status and general health. To protect all horses attending events, any Horse with a questionable health status concerning vaccination, disease or other concerns, must be stabled within the isolation facilities provided by the Organising Committee pending a decision on entering the venue.

7.4. HORSE INSPECTIONS. FEI Veterinary Regulations Articles 1034-1042

All Horses will be assessed for their fitness to compete during the Horse Inspection. Any Horse demonstrating questionable fitness may be referred to the Holding Box for further veterinary examination. Horses not deemed fit to compete by the Inspection Panel will not be permitted to compete.

7.5. LIMB SENSITIVITY EXAMINATION. FEI Veterinary Regulations Articles 1048-1053

All Horses are subject to examination under the protocol for abnormal limb sensitivity throughout the period of an Event. For Jumping that includes, but is not limited to, between rounds and before the Jump Off. Horses may be examined once or on multiple occasions during the Period of an Event.

Horses may be selected for examination under the protocol randomly or they may be targeted. All Horses selected to be tested must submit promptly to the examination or are subject to immediate disqualification. There is no obligation to examine any specific number of Horses at an Event.

8. EQUINE ANTI-DOPING AND CONTROLLED MEDICATION PROGRAMME (EADCMP). FEI VETERINARY REGULATIONS, CHAPTER VII

8.1. SAMPLING. FEI VETERINARY REGULATIONS Chapter VII

All horses competing at FEI Events may be subject to sampling for the presence of Prohibited Substances in accordance with the Anti-Doping and Controlled Medication Regulations (EADCMRs). Horses may be selected for sampling in accordance with obligatory testing, targeted or random sampling procedures. Refer to FEI Financial Charges for details of fees relating to Equine and Human Anti-Doping program (EADCMP), which OCs/NFs have the right to charge to the athlete (applicable for all FEI events worldwide).

8.2. ELECTIVE TESTING. FEI VETERINARY REGULATIONS ARTICLES 1058

Elective Testing may be carried out prior to an Event to check for the presence of Prohibited Substances. Please refer to <https://inside.fei.org/fei/cleansport/horses> for information and details.

XIII. HUMAN ANTI-DOPING

Athletes can be tested at any FEI Event, by the FEI or by other Anti-Doping Organisations with Testing jurisdiction. Organisers will have the responsibility to provide facilities and staff/volunteers to facilitate such Testing if requested by the FEI as outlined in article 22.3 of the FEI's Anti-doping Rules for Human Athletes (ADRHA).

The ADRHA rules are published on the FEI website at <http://inside.fei.org/content/anti-doping-rules>.

XIV. ADDITIONAL INFORMATION

1. THE FEI POLICY FOR ENHANCED COMPETITION SAFETY DURING THE COVID-19 PANDEMIC

The FEI Policy for Enhanced Competition Safety during the Covid-19 Pandemic ("Policy") (<https://inside.fei.org/system/files/FEI%20Policy%20for%20Enhanced%20Competition%20Safety%20during%20the%20Covid-19%20Pandemic%20-%20Effective%201%20July%202020.pdf>) is mandatory and applies for any FEI Event taking place **as of 1 July 2020**. The Policy has been developed based on currently accepted best practices by the WHO and US Center for Disease Control (CDC) and will be continually reviewed and updated as more information becomes available. It is not intended to replace the applicable guidance and policies from domestic government and health authorities, but to supplement their recommendations with sport specific considerations.

The OC shall submit the risk assessment and mitigation plan (including name and contact details of the person in charge) to the FEI as an annex to the Event Schedule, **at the latest ten (10) working days before the event's deadline for Definite Entries**.

Events for which the FEI has not received the documented risk assessment and mitigation measures plan in accordance with article 2.1.g) of the Policy **will be removed from the FEI calendar** in accordance with Article 112.3 of the FEI General Regulations.

ASSUMPTION OF RISK / WAIVER OF LIABILITY

In consideration of being allowed to participate in the Event and related activities, all Participants (as defined in the Policy) acknowledge, appreciate, and agree that:

1. Participation includes possible exposure to and illness from infectious diseases including but not limited to COVID-19. While particular rules and personal discipline may reduce this risk, the risk of serious illness and death does exist; and,
2. The Participants knowingly and freely assume all such risks, both known and unknown, even if arising from the negligence of the OC or others, and assume full responsibility for their participation; and,
3. The Participants willingly agree to comply with the stated and customary terms and conditions for participation as regards protection against infectious diseases. If, however, a Participant observes any unusual or significant hazard during his/her presence or participation, the Participant will remove himself/herself from participation and bring such to the attention of the nearest official immediately; and,
4. The Participants, for themselves and on behalf of their heirs, assigns, personal representatives and next of kin, HEREBY RELEASE AND HOLD HARMLESS THE OC AND THE FEI, their officers, officials, agents, and/or employees, other participants, sponsoring agencies, sponsors, advertisers, and if applicable, owners and lessors of

premises used to conduct the event ("RELEASEES"), WITH RESPECT TO ANY AND ALL ILLNESS, DISABILITY, DEATH, or loss or damage to person or property, WHETHER ARISING FROM THE NEGLIGENCE OF RELEASEES OR OTHERWISE, to the fullest extent permitted by law.

The Participants confirm to have read this release of liability and assumption of risk agreement, fully understand its terms, understand that they have given up substantial rights.

2. INSURANCES AND NATIONAL REQUIREMENTS

Equestrian sports involve inherent dangerous risks. To the greatest extent permitted by law, the FEI and the FEI Event Organiser shall NOT be liable for any damages relating to loss of property or injury of any kind to Athletes, Owners, Support Personnel or Horses at or in connection with an FEI Event and the FEI expressly excludes all such liability.

2.1. ATHLETES, OWNERS AND SUPPORT PERSONNEL

2.1.1. Personal Accident and Health Insurance

It is your responsibility as an Athlete/Owner/ Support Personnel to ensure that you have adequate personal accident insurance in place to cover your participation at FEI Events and in particular to insure against any personal injury or medical expenses arising from an accident, injury or illness which may occur at a FEI Event.

You should check with your National Federation to confirm if your National Federation's insurance policy (if any) covers personal accidents and/or illnesses which may occur when you are attending/participating in FEI Events.

If your National Federation does not have a personal accident/health insurance policy or if the National Federation's insurance policy does not cover personal accident or health claims, then you should obtain your own personal accident and health insurance policy to cover your attendance/participation at FEI Events.

2.1.2. Personal Property Insurance

You should also ensure that you are insured against property loss, theft or damage which may occur at an FEI Event.

Again, the advice is to check with your National Federation to confirm if they have an insurance policy in place which would cover you in case of such property loss, theft or damage. If not, then you should obtain your own personal property insurance to cover such situations.

2.1.3. Press Equipment

Press equipment and other items left in the Press workroom, Press lockers, the Press Tribune or anywhere on the showgrounds are left entirely at the owner's risk. The Organising Committee does not accept any responsibility for any loss or damage to such equipment or items. Members of the Press are advised not to leave any equipment or personal items unattended.

2.2. ATHLETES AND OWNERS

2.2.1. Third Party Liability Insurance

As an Athlete/Owner you are personally responsible for damages to third parties caused by you, your employees, Support Personnel, your agents or your Horses. You are, therefore, strongly advised to take out third-party liability insurance providing full coverage in relation to

FEI Events at home and abroad, and to keep the policy up to date.

The FEI and the Organiser will NOT be responsible for any damage caused to third parties by you, your employees, Support Personnel, your agents or your Horses.

2.2.2. Additional Liability Information

2.2.3. Horse Insurance

As an Owner you should ensure that your Horses are adequately insured against any injuries or illnesses they may sustain while participating at a FEI Event.

3. PROTESTS/APPEALS

To be valid, all Protests and Appeals must be made in writing and accompanied by a deposit of CHF 150.- or equivalent.

Protest and appeal forms are available on the FEI website:

Protests: <http://inside.fei.org/sites/default/files/FEI%20Protest%20Form.pdf>

Appeals: <http://inside.fei.org/sites/default/files/FEI%20Appeal%20Form.pdf>

4. SCHOOLING DURING COMPETITIONS

Athletes wishing to school during speed competitions (Table A and Table C) must inform the OC before these competitions begin. These athletes will start first in these competitions.

5. STEWARDING

- If an athlete is uncertain as to whether the boots he/she intends to use during an event are allowed, he/she or his/her representative should show the boots to the Chief Steward for his/her opinion before the boots are used in training or in competition.
- In addition, athletes are to be made aware that hind boots must be removed and placed again on the horse's legs in the presence of a Steward while in the warm-up arena prior to entering the competition arena for certain competitions. (If bandages are used in place of boots, athletes are not required to remove the bandages in the warm-up arena.) This procedure is compulsory for competitions for which boot and bandage control is mandatory, that is the Nations Cup, Grand Prix, and the competition with the highest prize money, and is at the discretion of the Chief Steward for other competitions.
- As an alternative to carrying out this procedure at the time designated by the Steward an athlete may ask his/her groom to take the boots to the in-gate and place them on the horse's legs in front of the Steward prior to the combination entering the arena.
- The Steward has the authority to intervene if a boot is deemed excessively tight by instructing that the boot be removed and put on again correctly. *[Stewards are to note*

that it is normal for a horse's gait to be somewhat affected immediately after boots have been removed and re-placed.] If an athlete or his/her groom refuses to remove and re-place the boot(s) when instructed to do so by the Steward, a Yellow Warning Card will be issued to the athlete in question.

- If it is deemed impossible or unsafe to remove the hind boots in the warm-up arena prior to the combination entering the competition arena, due to an extremely excited or nervous horse, the boots of the horse in question are to be removed by the athlete/groom following the athlete's round upon leaving the arena and inspected by the Steward. This inspection may be carried out during the boot and bandage control if the boot and bandage control is carried out for the competition in question.
- This procedure does not replace boot and bandage control after completion of an athlete's round for competitions for which boot and bandage control is mandatory (refer to JRs Art. 244.1).

6. DISPUTES

In the event of any discussion concerning the interpretation of the schedule (in translated languages), the English version will be decisive.

7. MODIFICATION TO SCHEDULE

In exceptional circumstances, together with the approval of Chefs d'Equipe, host NF delegate, if any, and the Ground Jury, the Organiser may change the schedule in order to clarify any matter arising from an omission or due to unforeseen circumstances. Any such changes must be notified to all athletes and officials as soon as possible and they must be reported to the FEI Secretary General by the Technical Delegate, the President of the Ground Jury or the Foreign Judge, as applicable.

8. ADDITIONAL INFORMATION FROM THE OC

Space for organiser to include any additional information

FEI APPROVED SCHEDULE

Michalowice 21-31 October 2021

Age of Athletes and Horses according to the Event's Category

Event's Category	Age of Athletes	Age of Horses
Olympic Games/WEG	As of 18 th year	Min 9 y.o.
Continental Championships Senior	As of 18 th year	Min 8 y.o.
Regional Championships/Games	As of 18 th year As of 16 th year if height of obstacles max.1.40m (JRs Annex IX, Art. 6.1)	Min. 8 y.o. Min. 7 y.o. if height of obstacles max. 1.40m (JRs Art. 254.1.1)
World Cup Final	As of 18 th year	Min. 9 y.o.
Nations Cup Final	As of 18 th year	Min. 8 y.o.
CSI-W1*-5*/CSIO-W1*-5* Grand Prix, World Cup, Nations Cup, Power and Skill, Derby or Competition with the highest prize money Other Competitions Other Competitions if height max. 1.40m Other Competitions if height max. 1.30m	As of 18 th year As of 16 th year with permission of their NF As of 14 th year " " As of 12 th year " "	Min. 7 y.o. Min. 7 y.o. Min. 7 y.o. Min. 7 y.o.
CSI3*-5*/CSIO3*-5* Grand Prix, Nations Cup, Power and Skill, Derby or Competition with the highest prize money Other Competitions Other Competitions if height max. 1.40m Other Competitions if height max. 1.30m	As of 18 th year As of 16 th year with permission of their NF As of 14 th year " " As of 12 th year " "	Min. 7 y.o.
CSI2* Power and Skill or Derby Grand Prix Other Competitions if height max. 1.40m Other Competitions if height max. 1.30m	As of 18 th year As of 16 th year with permission of their NF As of 14 th year " " As of 12 th year " "	Min. 6 y.o.
CSIO2* Nations Cup, Grand Prix, Power and Skill, Derby or Competition with the highest prize money Other Competitions Other Competitions if height max. 1.40m Other Competitions if height max. 1.30m	As of 18 th year As of 16 th year with permission of their NF As of 14 th year " " As of 12 th year " "	Min. 6 y.o. *
CSI1* Power and Skill or Derby Grand Prix / Other Competitions Other Competitions if height max. 1.30m	As of 18 th year As of 14 th year with permission of their NF As of 12 th year " "	Min. 6 y.o.
CSIO1* Nations Cup, Grand Prix, Power and Skill, Derby or Competition with the highest prize money Other Competitions Other Competitions if height max. 1.40m Other Competitions if height max. 1.30m	As of 18 th year As of 16 th year with permission of their NF As of 14 th year " " As of 12 th year " "	Min. 6 y.o.
CH-Y	As of 16 th year to end 21 st year	Min. 7 y.o.
CSI/CSIO-Y	As of 16 th year to end 21 st year	Min. 7 y.o.
CH-J	As of 14 th year to end 18 th year	Min. 7 y.o.
CSI/CSIO-J	As of 14 th year to end 18 th year	Min. 6 y.o.
CSI/CSIO-Ch/CH-Ch	As of 12 th year to end 14 th year	Min. 6 y.o.
CSI/CSIOP/CH-P	As of 12 th year to end 16 th year Ponies must be registered as ponies with FEI	Min. 6 y.o.
CSIU-25	As of 16 th year to end 25 th year As of 14 th year if height max. 1.40m	Min. 7 y.o.
CSIV	As of 45 th year	Min. 6 y.o.
CSIAm	As of 12 th year until end of 13 th year if competition height is max. 1.30 m; as of 14 th year if height exceeds 1.30 m.	Min. 6 y.o.
CSIYH	Per Art. 255.2	Min. 5 y.o. – Max. 8 y.o.
CH-M-YH-S	As of 18 th year or 16 year for athletes qualified with the same horse	5 y.o. / 6 y.o. / 7 y.o.

Art. 254.1.1: Horses entered for CSIO2 Events at which the Nations Cup is built to the dimensions set forth in JRs Art. 264.3 for 2* Events must be at least 6 years old; Horses entered for CSIO2* Events at which the Nations Cup is built to the dimensions set forth in JRs Art. 264.3 for 3* Events or higher must be at least 7 years old.

9. PRIZE MONEY DISTRIBUTION

Prize Money Distribution Chart 1: Prize money distribution with 25% of prize money for the winner updated 30.01.2019

N° of starters	up to 11	12-48		49-100		101-110 declared starters		111-120 declared starters	
N° of prizes	Same as the number of starters who finish the competition	12		First 12 acc. to percentages below; extra prizes for 13 th to last*		First 16 acc. to percentages below; extra prizes for 17 th to last*		First 20 acc. to percentages below; extra prizes for 21 st to last*	
Prize money	Example: Competition prize money = 40'000.-	100% = 40'000		100% = 40'000		133% = 53'200		166% = 66'400	
		%		%		%		%	
1	All athletes who complete the competition receive prize money, to be distributed according to the percentages at right from the 1 st placed to the last placed athlete. The remaining prizes, i.e. the prizes foreseen up to 12 th place, are then distributed in descending order starting again with the 1 st placed athlete until there are no more prizes to be distributed. See examples below. 5 athletes: winner gets prize for 1 st (25%) and the other athletes get the relevant percentages down to the last athlete, i.e. 5 th place (7%). The prize for 6 th (5.5%) is then given to the winner, the prize for 7 th (4%) is given to the 2 nd placed athlete, the prize for 8 th (3%) is given to the 3 rd placed athlete, the prize for 9 th (3%) is given to the 4 th placed athlete and the prize for 10 th (2.5%) is given to the 5 th placed athlete. The prize for 11 th (2.5%) is then given to the 1 st placed athlete and the prize for 12 th (2.5%) is given to the 2 nd placed athlete. 10 athletes: winner gets prize for 1 st (25%) and 11 th (2.5%), second placed gets prize for 2 nd (20%) and 12 th (2.5%); the remaining athletes receive the prize money for their placing as per the percentages from 3 rd to 10 th place.	25	10'000	25	10'000	25	13'300	25	16'600
2		20	8000	20	8000	20	10'640	20	13'280
3		15	6000	15	6000	15	7980	15	9960
4		10	4000	10	4000	9	4788	8	5312
5		7	2800	7	2800	6.5	3458	6	3984
6		5.5	2200	5.5	2200	5	2660	4.5	2988
7		4	1600	4	1600	3.5	1862	3	1992
8		3	1200	3	1200	2.5	1330	2.5	1660
9		3	1200	3	1200	2.5	1330	2.5	1660
10		2.5	1000	2.5	1000	2	1064	2	1328
11		2.5	1000	2.5	1000	2	1064	2	1328
12		n/a	2.5	1000	2.5	1000	2	1064	2
Total	40'000	100%	40'000	100%	40'000				
13						1.5	798	1.5	996
14						1.5	798	1.5	996
15						1	532	1	664
16						1	532	1	664
Total						100%	53'200		
17								1	664
18								0.5	332
19								0.5	332
20								0.5	332
Total								100%	66'400
									Extra prizes for 21 st to last place*

* The OC must provide additional prizes for the remaining placed athletes to fulfil quota of one prize per four athletes. The amount to be given to each of these athletes must be stated in the Schedule.

Prize Money Distribution Chart 2: Prize money distribution with 33% of prize money for the winner updated 30.01.2019

N° of starters	up to 11	12-48		49-100		101-110 declared starters		111-120 declared starters	
N° of prizes	Same as the number of starters who finish the competition	12		First 12 acc. to percentages below; extra prizes for 13 th to last*		First 16 acc. to percentages below; extra prizes for 17 th to last*		First 20 acc. to percentages below; extra prizes for 21 st to last*	
Prize money	Example: Competition prize money = 40'000.-	100% = 40'000		100% = 40'000		133% = 53'200		166% = 66'400	
		%		%		%		%	
1	All athletes who complete the competition receive prize money, to be distributed according to the percentages at right from the 1 st placed to the last placed athlete. The remaining prizes, i.e. the prizes foreseen up to 12 th place, are then distributed in descending order starting again with the 1 st placed athlete until there are no more prizes to be distributed. See examples below. 5 athletes: winner gets prize for 1 st (25%) and the other athletes get the relevant percentages down to the last athlete, i.e. 5 th place (7%). The prize for 6 th (5.5%) is then given to the winner, the prize for 7 th (4%) is given to the 2 nd placed athlete, the prize for 8 th (3%) is given to the 3 rd placed athlete, the prize for 9 th (3%) is given to the 4 th placed athlete and the prize for 10 th (2.5%) is given to the 5 th placed athlete. The prize for 11 th (2.5%) is then given to the 1 st placed athlete and the prize for 12 th (2.5%) is given to the 2 nd placed athlete. 10 athletes: winner gets prize for 1 st (25%) and 11 th (2.5%), second placed gets prize for 2 nd (20%) and 12 th (2.5%); the remaining athletes receive the prize money for their placing as per the percentages from 3 rd to 10 th place.	33	13'200	33	13'200	33	17'556	33	21'912
2		20	8000	20	8000	19.5	10'374	19.5	12'948
3		15	6000	15	6000	14.5	7714	14.5	9628
4		10	4000	10	4000	9.5	5054	8.5	5644
5		6	2400	6	2400	5.5	2926	5	3320
6		4.5	1800	4.5	1800	4	2128	3.5	2324
7		3	1200	3	1200	2.5	1330	2.5	1660
8		2.5	1000	2.5	1000	2	1064	2	1328
9		2	800	2	800	2	1064	2	1328
10		2	800	2	800	2	1064	2	1328
11		1	400	1	400	1	532	1	664
12		n/a	1	400	1	400	1	532	1
Total	40'000	100%	40'000	100%	40'000				
13						1	532	1	664
14						1	532	1	664
15						1	532	1	664
16						0.5	266	0.5	332
Total						100%	53'200		
17								0.5	332
18								0.5	332
19								0.5	332
20								0.5	332
Total								100%	66'400
									Extra prizes for 21 st to last place*

* The OC must provide additional prizes for the remaining placed athletes to fulfil quota of one prize per four athletes. The amount to be given to each of these athletes must be stated in the Schedule.

In case of a tie for the 12th place in a competition with 12 to 48 starters, the prize money foreseen for the 12th place will be divided equally among the athletes concerned.

For Competitions run in two rounds with more than 12 starters in 2nd round:

OCs that indicate in the schedule that a specific number (that is more than 12) of athletes will return for the second round will be permitted to distribute the prize money for that competition among all the athletes taking part in the second round, even if the second round is followed by a jump-off in case of a tie on penalties for first place after the second round.

DEDUCTIONS FROM PRIZE MONEY AT COMPETITIONS:

Full details of any deductions from prize money must be outlined in the schedule. This includes government taxes. If it is necessary for Organisers to deduct such taxes, they must provide participants with an official form indicating the amount of tax deducted.

The tax form must be provided to the athletes upon arrival and returned to the Organiser prior to departing.

All prizes above 2000 pln are subject to Polish income tax - 10%. The amount of prize money for one Athlete above 3000 pln will be transferred into the account of the Rider up to 7 days after the last day of the show. The OC asks all the riders to fill in the document on the arrival with the bank details.

IMPORTANT

The total amount of prize money shown for each Competition in the schedule must be distributed. (FEI General Regulations articles 127 and 128)

For details of the prize money breakdown for each competition please refer to the tables at the end of this document; the Organiser must specify which of the two (2) tables will be used. The total prize money for the Competition must be distributed among the first twelve (12) placed athletes.

The Organiser must provide additional prizes for athletes placed beyond twelfth (12th) place. The minimum amount for each of these additional prizes, for athletes placed from thirteenth (13th) to last place, must be clearly specified in the approved schedule and not exceed the prize money of the athlete placed twelfth (12th)

10. MAXIMUM NUMBER OF STARTERS PER COMPETITION

***Annex VI FEI Jumping Rules:**

Maximum 100 starters per Competition other than the GP. If more than 100 starters are declared, the OC must provide the following percentages of additional prize money for every ten declared starters, up to 120 declared starters:

- 101 to 110 declared starters: the OC must provide 133% of the original Competition prize money, which is to be distributed among the 16 best placed athletes in the Competition according to the prize money distribution chart I or II. The additional prize money provided by the OC is not taken into consideration with regard to the overall prize money that determines the star level of the Event or the Longines Ranking point group of the Competition, if applicable.
- 111 to 120 declared starters: the OC must provide 166% of the original Competition prize money, which is to be distributed among the 20 best placed athletes in the Competition according to the prize money distribution chart I or II. The additional prize money provided by the OC is not taken into consideration with regard to the overall prize money that determines the star level of the Event or the Longines Ranking point group of the Competition, if applicable.

If more than 120 starters are declared, the OC must split the Competition into two groups and provide 200% of the original Competition prize money which is to be divided equally between the two groups. The additional prize money provided by the OC is not taken into consideration with regard to the overall prize money that determines the star level of the Event or the Longines Ranking point group of the Competition, if applicable.

OCs may apply either of the following methods for splitting the Competition:

The competition is split into two groups before it starts. There may be athletes with multiple horses in each group but all horses of any one athlete must be in the same group. If it is not possible to have two groups of equal size there may be a different number of starters in each group;

OR

The competition is run as one single competition and split afterward into two groups and the classification established as follows: the athlete with the best score is the winner of the first group, the athlete with the second best score is the winner of the second group and so on until prizes have been allocated to 25% of the total number of starters. *NB: In this case separate results must be sent to the FEI for each of the two groups, e.g. results for Competition 1a and for Competition 1b.*

In both cases above each group must offer the same amount of prize money. For the avoidance of doubt, it is the number of declared starters in the Competition, not the final number of starters, that determines whether the Competition must be split.

If there are more than 200 declared starters, the OC must split the Competition into three groups and provide the same percentages of additional prize money as indicated above (100% of original Competition prize money to be provided for each of the three groups if each group has 100 or fewer starters; 133% of original prize money to be provided for each group if any of the three groups has 101-110 starters; 166% of original prize money to be provided for each if any of the three groups has 111-120 starters).

³ For CSI-W Events with a Grand Prix Competition in addition to the FEI World Cup™ competitions, the minimum prize money requirements indicated above for the Grand Prix apply only to the FEI World Cup™ Competition as it has the status of a Grand Prix; the Grand Prix Competition at such Events cannot offer more prize money than the prize money offered for the FEI World Cup™ Competition. Refer to the FEI Jumping World Cup™ rules for details relating to date of implementation of this rule at CSI-W Events.

11. GLOSSARY

***Glossary FEI Jumping Rules:**

Fees:

- Compulsory Fee: Compulsory Fees are fees that may be charged by the OC for costs/services not included in the Entry Fee. Compulsory Fees, if charged, must be paid by the Athletes concerned as outlined below. Only the following Compulsory Fees may be charged by the OC, providing full details of the amount to be charged is included in the Schedule and approved by the FEI:
 - NF fee if applicable
 - NF medication control programme fee if applicable
 - FEI EADCMR fee if applicable (OC to indicate in the Schedule if the EADCMR fee is included in the Entry Fee or not)
 - Fee for health/customs-related documents for Horses if these have been requested by the Athlete.
 - Fee for manure disposal (maximum € 40 per horse per Event)
 - Fee for lorry parking if applicable (The fee indicated in the Schedule may only be charged per lorry not per Athlete.)
 - Fee for electric hook-up for lorry (The fee indicated in the Schedule may only be charged per lorry, not per Athlete.)
- Discretionary Fee: Discretionary Fees are fees that may be charged for optional commodities/services that may be purchased by an Athlete if he so chooses and that do not affect the equity of the Athlete's right to compete at the Event or the well-being of the Horse, such as:
 - VIP or premium parking
 - VIP table

- Extra box for tack or for non-competing Horse
 - Extra bedding and/or fodder (details to be included e.g. shavings, straw, hay)
 - Premium stabling (all stabling at the Event must meet minimum FEI requirements)
- Entry Fee: The Entry Fee is the fee charged to participate in an Event with one Horse and covers the following:
- Stabling of one Horse for the duration of the Event (includes cleaning and disinfecting stables before the event, including between Events that are part of Tours, water and electricity in the stables, first bedding or a fixed amount of bedding depending on the type of event and 24 hour security services for the stables)
 - Use of all facilities at the Event (no infrastructure fees may be charged)
 - Right to participate in all Competitions in accordance with the conditions in the Schedule (no nomination fees or start fees may be charged)
 - Administrative/Office fees (includes all services relating to administration of the Event and running of the Competitions: data/results/timing services, bookkeeping and accreditation services)

XV. ANNEXES

1. FEI ENTRY SYSTEM

Please fill the form below in order to provide you and the other members of your committee or your IT Providers access to the FEI Entry System.

FEI ID¹: 10032902
Name*: Szary-Ziębicka
First Name*: Anna
E-Mail*: ania.szary@kjkszary.pl
Access Rights*: Admin² Consult³
Events⁴:

FEI ID¹: 10052103
Name*: Tarant
First Name*: Szymon
E-Mail*: szymon@tarantevents.pl
Access Rights*: Admin² Consult³
Events⁴:

FEI ID¹:
Name*:
First Name*:
E-Mail*:
Access Rights*: Admin² Consult³
Events⁴:

¹ If already have an FEI user account.

² Provides you the required access to manage entries and substitutions and download entries/lists.

³ You are just able to consult and download the entries/lists.

⁴ Leave the field blank if the user deals with the entries of all events in the show.

* **Mandatory Fields**

2. RESULTS

In order to proceed with the results publication and for qualification purposes the FEI requires results **to be uploaded directly on the FEI Database** within two days after the conclusion of the event.

All relevant information, file format and tutorial can be found on this page:

<http://inside.fei.org/fei/your-role/organisers/xml-format>

If you or your provider are unable to produce the required files, results will be accepted by e-mail to results@fei.org, in the proper Excel or "XML" format immediately after the event.

Please refer to compulsory format for CSIs/CSIOs/Championships and Games; the file can be downloaded using the following link:

<https://inside.fei.org/fei/your-role/it-services/results/jumping-results-forms>

All results must include FEI Passport Registration number of horses and FEI ID number of Riders.

Please note that as per Art. 109.6 (GR): OCs of International Jumping Events must inform the FEI and NFs whose teams or individuals have taken part, of the results and prize money paid to each placed Athlete and team, within two (2) days following the Event, unless otherwise specified for qualification and ranking reasons as communicated by the FEI. Failure from OCs of International Events to provide the FEI with the appropriate result(s) and/or prize money information by the aforesaid deadline and/or in the aforesaid format shall entail a warning for the first violation and thereafter a fine of CHF 1'000.- per violation.

THE APPENDIX (8 PAGES) IS PART OF THIS APPROVED AND SIGNED SCHEDULE AND MUST BE DISTRIBUTED TO ALL OFFICIALS AND NFs AND IS AVAILABLE TO OTHERS UPON REQUEST